

RE•Series™ Tankless Water Heaters

The First and Only Non-Condensing Unit with a Built-In Pump and Featuring Smart-Circ™ Intelligent Recirculation™



**Proudly assembled at our
new manufacturing facility
in Griffin, Georgia, USA**

RE•Designed for the Way You Work

NEW

Easy open/close and clean internal layout, for fast access to components

NEW

Sleek redesign means fewer fasteners, for easy access to serviceable components

NEW

Updated integrated control screen for fast set-up and easy troubleshooting

Programmable service reminders simplify scheduled maintenance

NEW

Two models with built-in recirculation pump for faster, value-added installs

Optional

Freeze protection drain-down accessory protects home and water heater

NEW

Lower BTU models (indoor and outdoor) allow appropriate sizing for the application

Compact copper heat exchanger

for superior non-condensing performance; better heat transfer at higher temperatures

NEW

Built-in recirculation control

Smart-Circ™
Intelligent Recirculation™

NEW

Smart-Circ™ Intelligent Recirculation™ “learns” users’ hot water patterns to schedule recirculation

Optional

Leak detection kit reduces homeowner emergencies, for added peace of mind

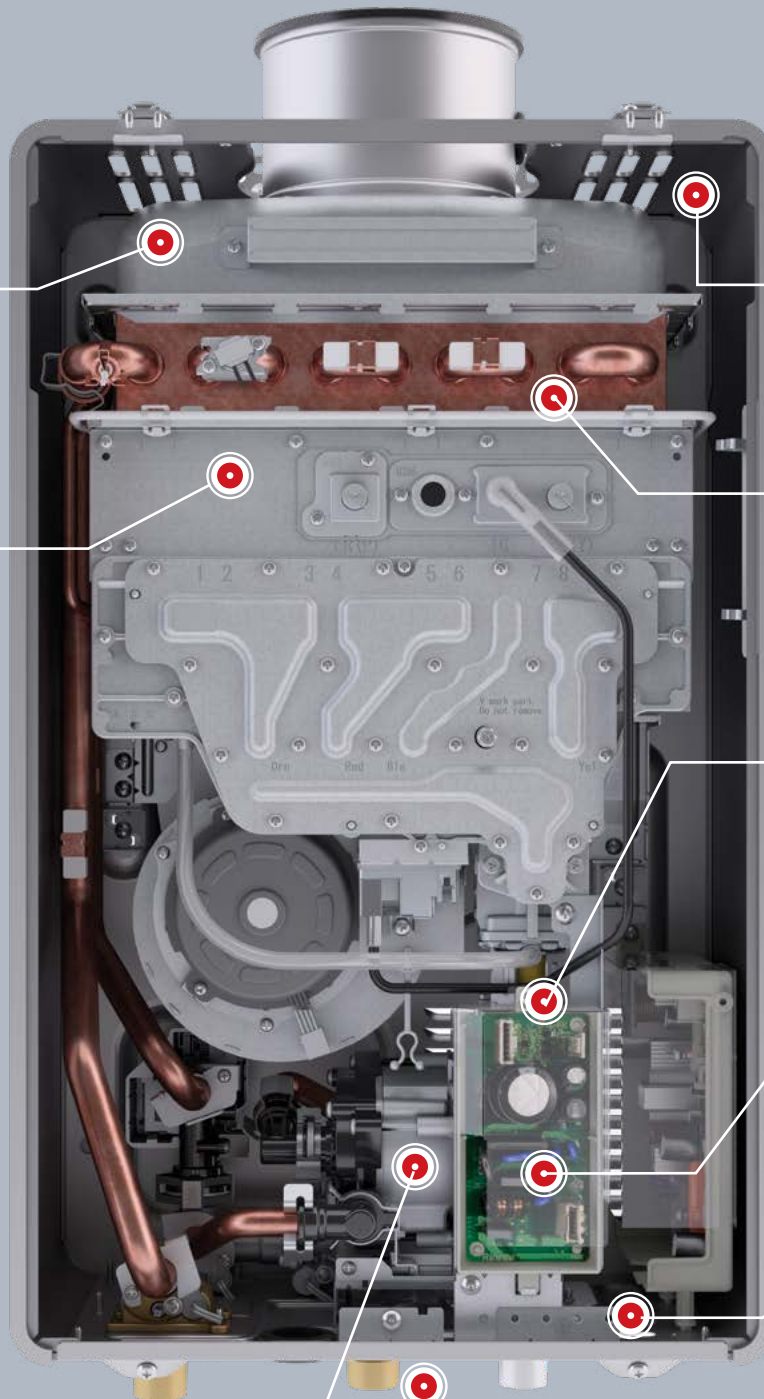

NOTE: Model shown includes pump.

RE•SERIES™

Rinnai Efficiency Series

The Most Advanced Non-Condensing Tankless Water Heater

For more than 100 years, Rinnai has set the standard for innovation. And now we're raising the bar again. A completely revamped line of advanced non-condensing tankless water heaters is unlike anything else on the market, delivering a level of installation ease, serviceability, reliability and usability never before seen. All with an eye toward helping you work smarter, faster, and more successfully. All from the **first major brand manufactured in the USA**, creating jobs, boosting our local economy and breaking new ground in tankless water heating.



REP199e
Non-condensing Tankless Water Heater with Built-in Recirculating Pump

REP199i
Non-condensing Tankless Water Heater with Built-in Recirculating Pump

Smart Design

Newly designed from the inside out, Rinnai's RE•Series™ makes tankless water heating even smarter. We made improvements with an eye to speeding installation, enhancing serviceability, and boosting your profitability.

- **Clean internal layout**, new wiring harness, and fewer fasteners make it easy to see and access components
- **Safety handle and seating bracket** for heat exchanger and combustion system protect components
- **LED screen** lets you set maintenance/service reminders, provides error codes, and alerts for maintenance intervals
- **New sliding wall bracket** allows a single installer to hang and slide unit horizontally to align with venting before securing to drywall

Homeowners still enjoy a continuous supply of hot water, and you save time on installation, maintenance and service.

Smart Technology

The new Rinnai RE•Series™ is the **first and only non-condensing tankless water heater** with features such as:

- **Built-in recirculation control** for faster and less expensive installation of recirculation equipment
- **Recirculation-ready models** available with a built-in pump, works with either a dedicated return line or cross-over valve
- **Smart-Circ™ Intelligent Recirculation™** that "learns" a user's hot water usage patterns over a seven-day period, to schedule the pump and tankless recirculation patterns
- **Tested and approved for use** with cleaner-burning hydrogen-enriched natural gas
- **Multimedia technical support** with so many smart features, it's never been easier for you to sell Rinnai non-condensing tankless water heating. And it's never been easier for your homeowners to manage their hot water.



RE•Series™

How We Improved on a Legend

Regardless of the plumbing configuration, Rinnai can now provide faster hot water with select non-condensing tankless models featuring a built-in pump with recirculation technology.

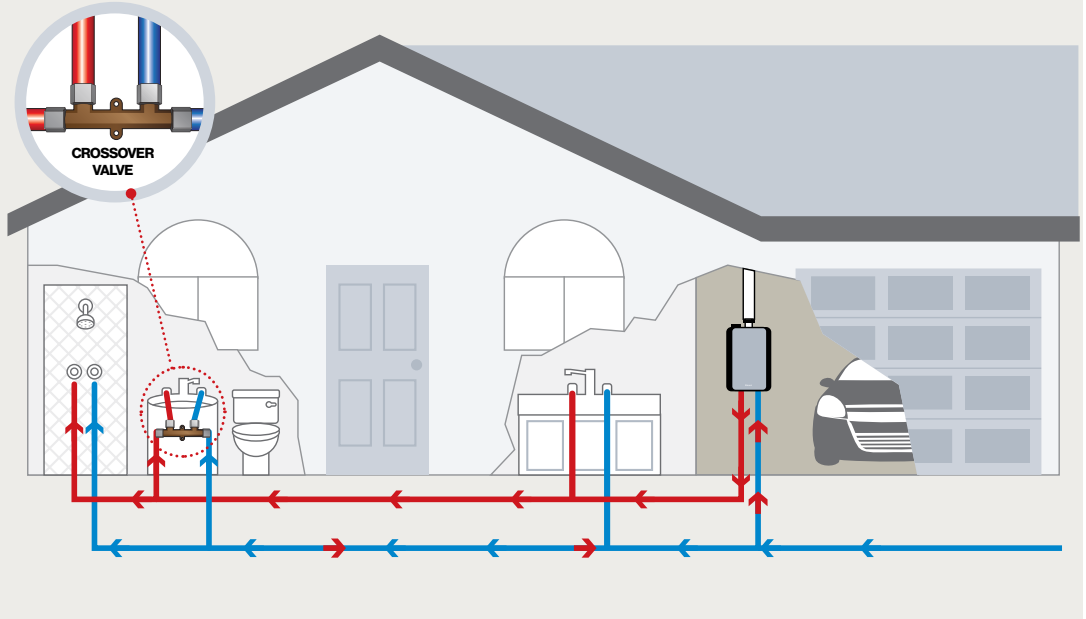

NON-CONDENSING PUMP MODELS

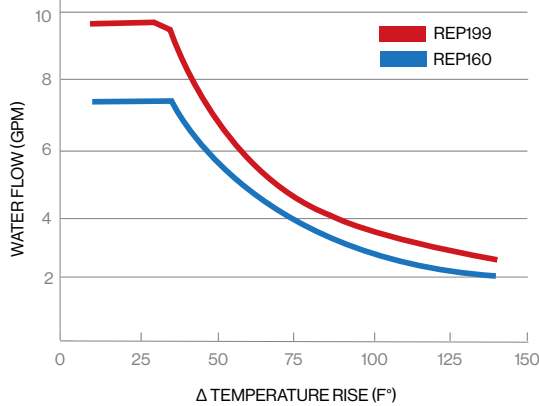

NON-CONDENSING MODELS

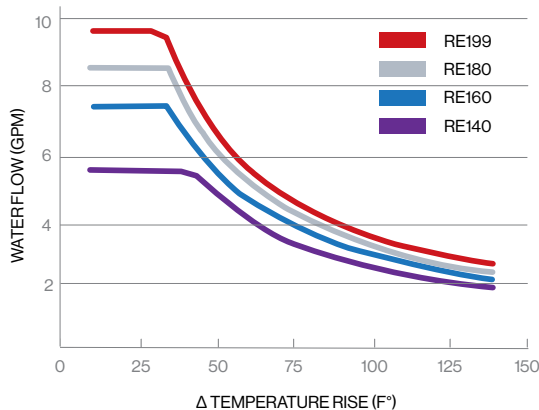

FLOW RATE VS. DELTA Δ TABLE (INDOOR MODELS)

	RE199 / REP199	RE180	RE160 / REP160	RE140
Max. BTUH	199,000	180,000	160,000	140,000
Recovery Efficiency*	83%	83%	83%	83%
Temperature Rise (F°)	GPM	GPM	GPM	GPM
140	2.4	2.1	1.9	1.7
135	2.4	2.2	2.0	1.7
130	2.5	2.3	2.0	1.8
125	2.6	2.4	2.1	1.9
120	2.8	2.5	2.2	1.9
115	2.9	2.6	2.3	2.0
110	3.0	2.7	2.4	2.1
105	3.1	2.8	2.5	2.2
100	3.3	3.0	2.7	2.3
95	3.5	3.1	2.8	2.4
90	3.7	3.3	3.0	2.6
85	3.9	3.5	3.1	2.7
80	4.1	3.7	3.3	2.9
75	4.4	4.0	3.5	3.1
70	4.7	4.3	3.8	3.3
67	4.9	4.5	4.0	3.5
65	5.1	4.6	4.1	3.6
60	5.5	5.0	4.4	3.9
55	6.0	5.4	4.8	4.2
50	6.6	6.0	5.3	4.6
45	7.3	6.6	5.9	5.2
40	8.3	7.5	6.6	5.3
35	9.4	8.5	7.4	5.3
30	9.7	8.5	7.4	5.3
25	9.7	8.5	7.4	5.3
20	9.7	8.5	7.4	5.3
15	9.7	8.5	7.4	5.3
10	9.7	8.5	7.4	5.3

*Recovery Efficiency ratings per AHRI Directory.

Smart-Circ™ Intelligent Recirculation™

Extraordinary Convenience. Unbeatable Efficiency.

With Smart-Circ™ installation just got easier. External controllers are no longer needed to ensure your customers have hot water when they need it. Smart-Circ™ “learns” users’ hot water patterns over a seven-day period, then schedules pump and tankless recirculation patterns accordingly. Users enjoy instant hot water during regular demand periods, while saving energy and money.

Smart-Circ™
Intelligent Recirculation™

Day 1

Morning Showers

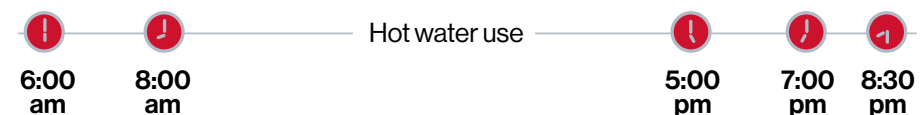

Days 2-7

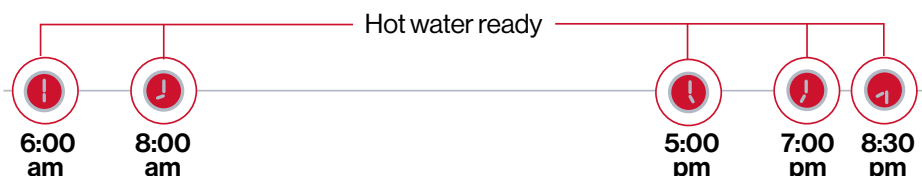

You're all set!

Hot water will be ready for you based on the previous day's schedule. As hot water events are added throughout the week, scheduled recirculation adjusts accordingly.

What about usage changes?



Smart-Circ™ does not distinguish between weekday and weekend patterns.



Unusual activity – like when users have guests – will set a usage pattern continuing 7 days after usage returns to normal.



To achieve scheduled recirculation or on-demand operation, control•r™ Wi-Fi module is required (sold separately). control•r™ Wi-Fi module overrides Smart-Circ™ recirculation patterns.

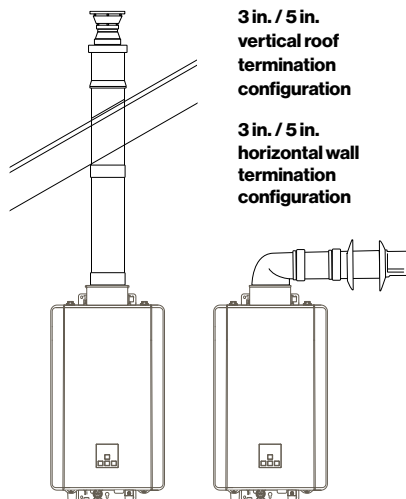

Optimized Concentric Venting for Non-Condensing Models

Rinnai Tankless Water Heaters were the first to use a unique concentric venting system – featuring an inner pipe for exhaust and an outer pipe for fresh air from outdoors. The result is a direct-vent, sealed combustion system that requires only one penetration through the wall or roof.

Venting available in vertical and horizontal configurations. Concentric structure allows hot exhaust to exit through interior pipe, while fresh air enters through the outer layer.

Wall Mounting Bracket, (REP models)

A versatile design enables side to side movement for easy vent alignment, intended to improve single contractor installation.

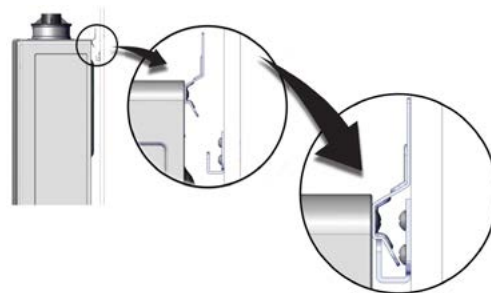

MODEL CHART AND SPECIFICATIONS

NON-CONDENSING TANKLESS WATER HEATERS

RE-Series™



Model	RE199i	RE199e	RE180i	RE180e	RE160i	RE160e
Cabinet Dimensions W x H x D Inches (mm)	14.05 x 22.87 x 10.77 (357 x 581 x 274)	14.05 x 22.87 x 10.77 (357 x 581 x 274)	14.05 x 22.87 x 10.77 (357 x 581 x 274)	14.05 x 22.87 x 10.77 (357 x 581 x 274)	14.05 x 22.87 x 10.77 (357 x 581 x 274)	14.05 x 22.87 x 10.77 (357 x 581 x 274)
Weight (lbs / kg)	42.1 lbs (19.1 kg)	42.1 lbs (19.1 kg)	42.1 lbs (19.1 kg)	42.1 lbs (19.1 kg)	38.5 lbs (17.5 kg)	38.3 lbs (17.4 kg)
Installation Type	Indoor	Outdoor	Indoor	Outdoor	Indoor	Outdoor
Min./Max. BTU (Natural Gas)	10,400 / 199,000	10,400 / 199,000	10,400 / 180,000	10,400 / 180,000	10,400 / 160,000	10,400 / 160,000
Min./Max. BTU (Propane)	10,400 / 199,000	10,400 / 199,000	10,400 / 180,000	10,400 / 180,000	10,400 / 160,000	10,400 / 160,000
Uniform Energy Factor/ Energy factor	0.82	0.82	0.82	0.82	0.81	0.81
Temp. Range Residential	98°F-140°F (37°C-60°C)	98°F-140°F (37°C-60°C)	98°F-140°F (37°C-60°C)	98°F-140°F (37°C-60°C)	120°F-140°F (49°C-60°C)	120°F-140°F (49°C-60°C)
Min. Activation Rate***	0.26 GPM	0.26 GPM	0.26 GPM	0.13 GPM	0.26 GPM	0.26 GPM
Hot Water Flow Rate Range	0.13-9.8 GPM (0.5-37 L/min)	0.13-9.8 GPM (0.5-37 L/min)	0.13-8.5 GPM (0.5-32 L/min)	0.13-8.5 GPM (0.5-32 L/min)	0.26-6.6 GPM (1.0-25 L/min)	0.26-6.6 GPM (1.0-25 L/min)
Ultra Low NOx	Yes					
Warranty (Residential)*	Limited 15-year on heat exchanger, 5-year on parts, 1-year on labor Register within 90 days and receive an additional 4 years of Labor coverage for FREE (\$250 value)					
Warranty (Commercial)*	Limited 8-year on heat exchanger, 5-year on parts, 1-year on labor Register within 90 days and receive an additional 1 year of Labor coverage for FREE					
Mobile Home Certified	Yes					
Valves Shipped in Box	No					
High Altitude Approved	Up to 10,200 feet					
Certifications	AHRI and CSA					
Venting Options	Non-Condensing Concentric	N/A	Non-Condensing Concentric	N/A	Non-Condensing Concentric	N/A
Controller (Standard)	Built In					
Controllers (Optional)**	MC-601-BK, MC-601-W, MC-195T-US, MCC-601, control•r™					
Wi-Fi Capable	Yes					

* For complete information and details regarding Rinnai's warranty, visit rinnai.us.

** To achieve temperatures over 140° F (60° C), an MCC-601 commercial controller must be purchased separately.

*** Temperature Dependent

For complete information on gas sizing for Rinnai Tankless Water Heaters, consult the Operation and Installation Manual.

RE•Series with Built-In Recirculation Pump



RE140i	RE140e	REP199i	REP199e	REP160i	REP160e
14.05 x 22.87 x 10.77 (357 x 581 x 274)	14.05 x 22.87 x 10.77 (357 x 581 x 274)	14.05 x 22.87 x 10.77 (357 x 581 x 274)	14.05 x 22.87 x 10.77 (357 x 581 x 274)	14.05 x 22.87 x 10.77 (357 x 581 x 274)	14.05 x 22.87 x 10.77 (357 x 581 x 274)
38.5 lbs (17.5 kg)	38.3 lbs (17.4 kg)	50 lbs (22.7 kg)	50.2 lbs (22.8 kg)	47 lbs (21.3 kg)	46.7 lbs (21.2 kg)
Indoor	Outdoor	Indoor	Outdoor	Indoor	Outdoor
10,400 / 140,000	10,400 / 140,000	10,400 / 199,000	10,400 / 199,000	10,400 / 160,000	10,400 / 160,000
10,400 / 140,000	10,400 / 140,000	10,400 / 199,000	10,400 / 199,000	10,400 / 160,000	10,400 / 160,000
0.81	0.81	0.81	0.81	0.81	0.81
120°F-140°F (49°C-60°C)	120°F-140°F (49°C-60°C)	120°F-140°F (49°C-60°C)	120°F-140°F (49°C-60°C)	120°F-140°F (49°C-60°C)	120°F-140°F (49°C-60°C)
0.26 GPM	0.26 GPM	0.26 GPM	0.26 GPM	0.26 GPM	0.26 GPM
0.26-5.3 GPM (1.0-20 L/min)	0.26-5.3 GPM (1.0-20 L/min)	0.26-7.9 GPM (1.0-30 L/min)	0.26-7.9 GPM (1.0-30 L/min)	0.26-6.6 GPM (1.0-25 L/min)	0.26-6.6 GPM (1.0-25 L/min)
Yes					
Limited 15-year on heat exchanger, 5-year on parts, 1-year on labor Register within 90 days and receive an additional 4 years of Labor coverage for FREE (\$250 value)					
Limited 8-year on heat exchanger, 5-year on parts, 1-year on labor Register within 90 days and receive an additional 1 year of Labor coverage for FREE					
Yes					
No	No	Yes	Yes	Yes	Yes
Up to 10,200 feet					
AHRI and CSA					
Non-Condensing Concentric	N/A	Non-Condensing Concentric	N/A	Non-Condensing Concentric	N/A
Built In					
MC-601-BK, MC-601-W, MC-195T-US, control•r™					
Yes					



Rinnai Manufacturing
Griffin, Georgia, USA

First Major Tankless Brand to Manufacture in the USA

Rinnai established its US operations in 1974 and introduced Tankless Water Heating to the North American Market in 1999. In 2018 Rinnai manufactured its first tankless water heater in the United States in Griffin, Georgia. Our new manufacturing facility was completed in 2021 with production of the new RE•Series™ tankless water heaters beginning in 2022. Rinnai continues to make significant investments in expanding its operations and product portfolio, focusing on its brand promise of **Creating a healthier way of living®**.



Water Heating Solutions



Home Heating Solutions



Commercial Water Heating Solutions

Every. Detail. Matters.™

You don't become a market leader without thinking through every single detail. Then overthinking it. Then rethinking it. Every small detail matters. A lot. From flexible venting to customizable solutions and maximum ROI, we've thought through all the possible barriers and potential problems before they exist. Simply put, we're not just in the business of tankless water heaters. We're in the business of solving problems. That means we won't relax. Ever. We just can't. We'll keep rethinking every single tiny detail, innovating, and improving our products, services, and programs.

Learn more about Rinnai high-performance Tankless Water Heaters, Hybrid Water Heating Systems, Boilers, Vent-Free Fan Convectors, EnergySaver® Direct Vent Wall Furnaces, Hydronic Air Handlers and Infrared Radiant Heaters.

rinnai.us



Rinnai America Corporation
103 International Drive | Peachtree City, GA 30269
1-800-621-9419 | rinnai.us

PROUD SPONSOR



FOLDS of HONOR