

# *CECO*

PORCELAIN ENAMELED CAST IRON KITCHEN SINKS



## CATALOG

QUALITY & STYLE | SYNCHRONIZED



In 1928, CECO founder Michael Hurray offered a superior line of porcelain enameled cast-iron sinks for residential and commercial plumbing applications. These products of supreme workmanship, versatile design, and resilient materials would deliver lasting value and stand the test of time.

For over four generations, family-owned CECO (Commercial Enameling Company) has become a mainstay feature of homes and businesses across the country. From kitchen and bathroom sinks in homes, schools, and hospitals to lavatories and floor sinks in supermarkets, restaurants, and cafes, CECO products are trusted to function impeccably whenever needed.

The CECO foundry was originally established to manufacture cast iron porcelain enamel sinks and sell them to neighboring families and businesses. In the heat of World War II, CECO shifted factory output to cast metal bomb casings that would be used by U.S. troops fighting abroad.

The Hurray family expanded the CECO product line to include kitchen and bar sinks, lavatories, laundry trays, service sinks, floor sinks, and accessories. Matthew and Mark Hurray eventually took over the reigns of CECO, but only after working their way up from the warehouse floor, to the foundry and enameling room, onto customer service and finally into sales and manufacturing.

Today, co-owners Matthew and Mark continue to deliver the CECO promise of quality craftsmanship and genuine care for each product that leaves their warehouse doors. Every CECO sink is a tribute to the pursuit of the dream that began back in 1928; where every satisfied customer is testimony to a brighter future ahead.

LAVATORY

BAR & ENTERTAINMENT

KITCHEN

UNDERMOUNTS

LAUNDRY

COMMERCIAL

**CECO**

(714) 656-1950

[cecosinks.com](http://cecosinks.com)



# Lavatory Sinks





# Lavatory Sinks



1310 E. Borchard Ave. • Santa Ana, CA 92705 • P 714.656.1950 • F 714.656.1969  
[www.cecossinks.com](http://www.cecossinks.com)



19 1/4" x 16 1/4" Oval Lavatory  
Tile, Metal Rim or Undercounter Mount  
Available in 4" or 8" Center Set

Accessories (Sold Separately)  
R1916 Mounting Rim  
UM 25 Undermount Kit



Cat. No.	Size	Center Set	Ship Wt.
578	19 1/4" x 16 1/4"	4"	35 lbs.
578	19 1/4" x 16 1/4"	8"	35 lbs.

ACID RESISTANT ENAMEL ON CAST IRON

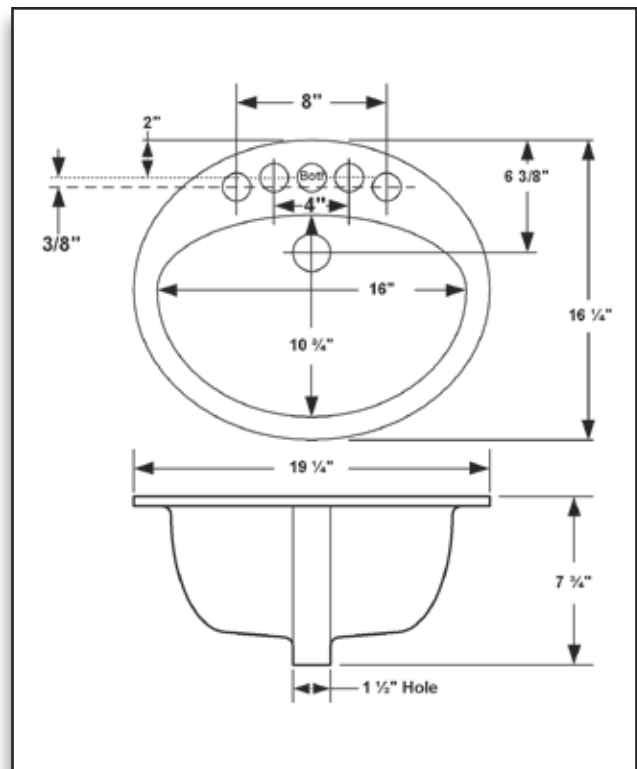
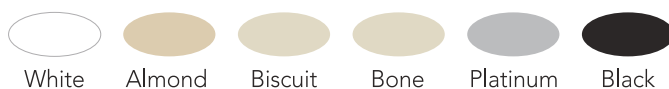



580  
581

# Maui

20" x 18" Rectangular Lavatory  
Tile, Metal Rim or Undercounter Mount

Accessories (Sold Separately)

R2018 Mounting Rim

UM 25 Undermount Kit



Maui

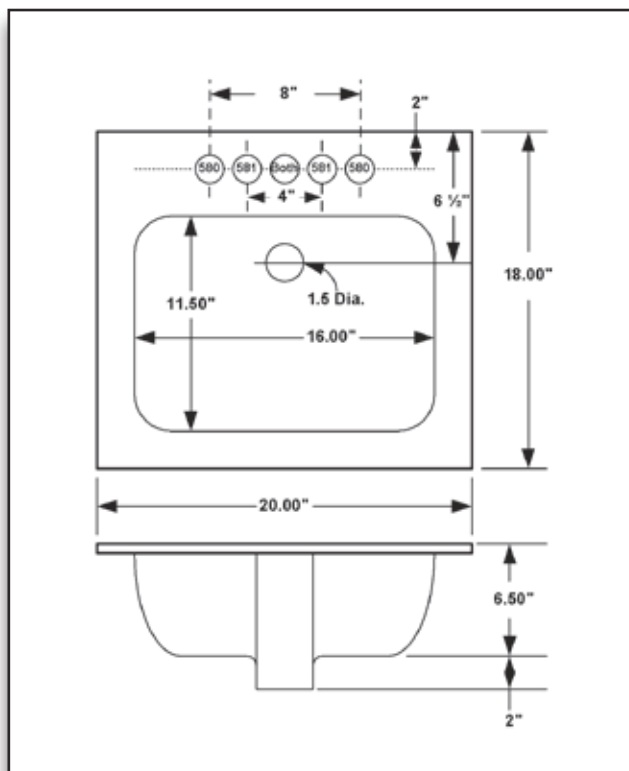

Cat. No.	Size	Center Set	Ship Wt.
580	20" x 18"	8"	52 lbs.
581	20" x 18"	4"	52 lbs.

ACID RESISTANT ENAMEL ON CAST IRON

\*Rough-in dimensions may vary 1/4"

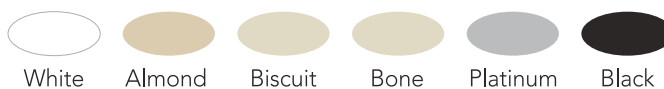

**CECO**

1310 E. Borchard Ave. • Santa Ana, CA 92705 • P 714.656.1950 • F 714.656.1969  
[www.cecocosinks.com](http://www.cecocosinks.com)



# Catalina

584  
585

Catalina

20" x 18" Rectangular Lavatory  
Tile - In or Undercounter Mount

Accessories (Sold Separately)  
UM 25 Undermount Kit



Cat. No.	Size	Center Set	Ship Wt.
584	20" x 18"	4"	52 lbs.
585	20" x 18"	8"	52 lbs.

ACID RESISTANT ENAMEL ON CAST IRON  
\*Rough-in dimensions may vary 1/4"

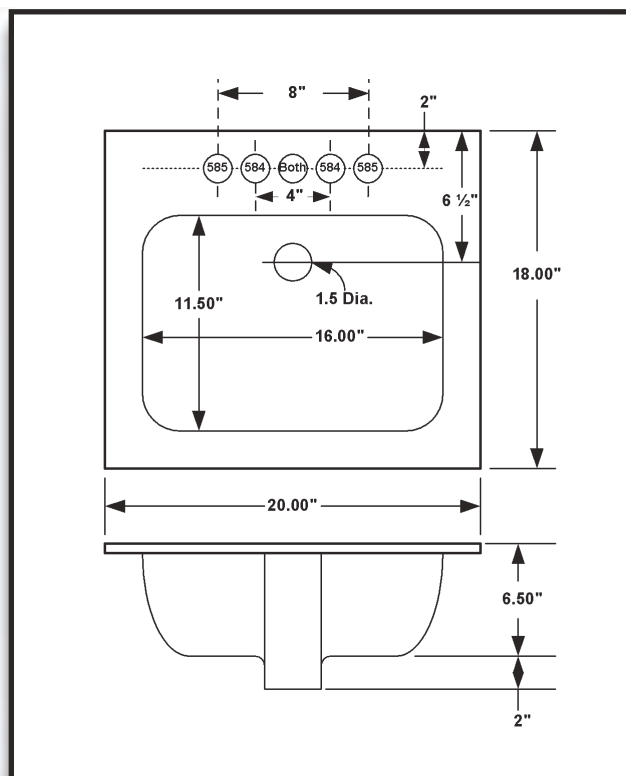
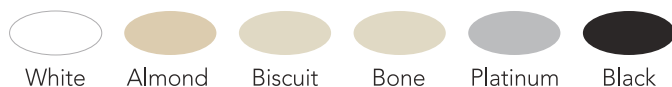



586  
587

# St. Kitts

21" x 19" Rectangular Lavatory  
Self Rimming

St. Kitts

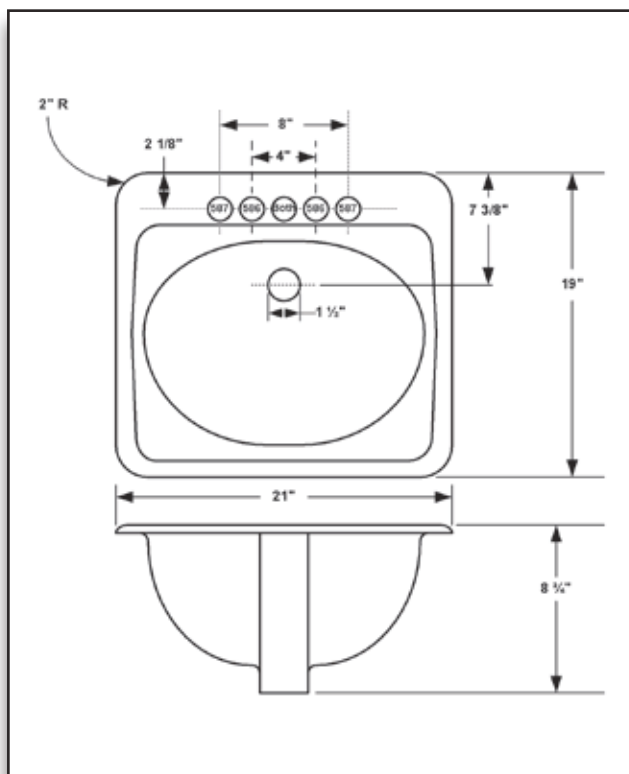

Cat. No.	Size	Center Set	Ship Wt.
586	21" x 19"	4"	48 lbs.
587	21" x 19"	8"	48 lbs.

ACID RESISTANT ENAMEL ON CAST IRON  
\*Rough-in dimensions may vary 1/4"





19 1/4" x 16 1/4" Oval Lavatory  
Self Rimming



Cat. No.	Size	Center Set	Ship Wt.
588	19 1/4" x 16 1/4"	4"	40 lbs.
589	19 1/4" x 16 1/4"	8"	40 lbs.

ACID RESISTANT ENAMEL ON CAST IRON  
\*Rough-in dimensions may vary 1/4"

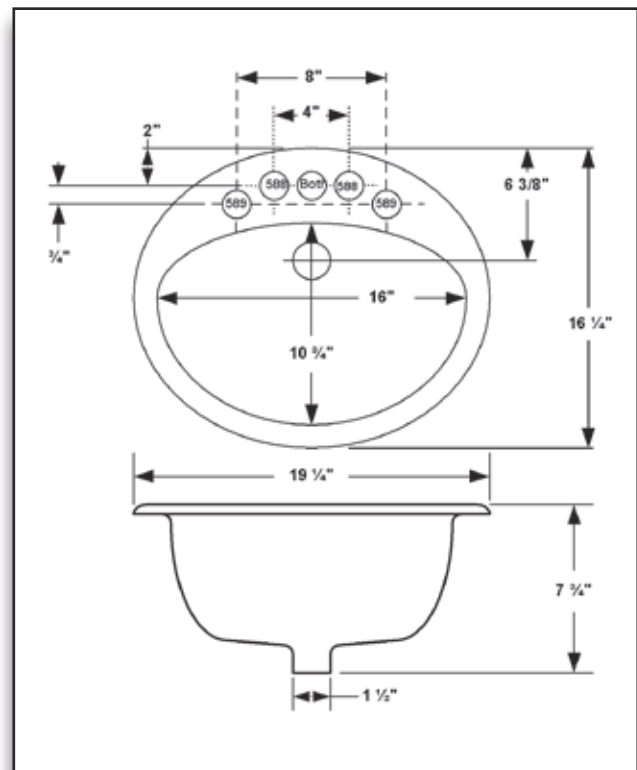
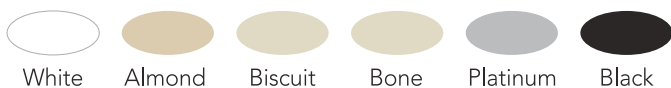



596  
597

# Nevis

19" Round Lavatory  
Self Rimming  
Available in 4" or 8" Center Set



Nevis

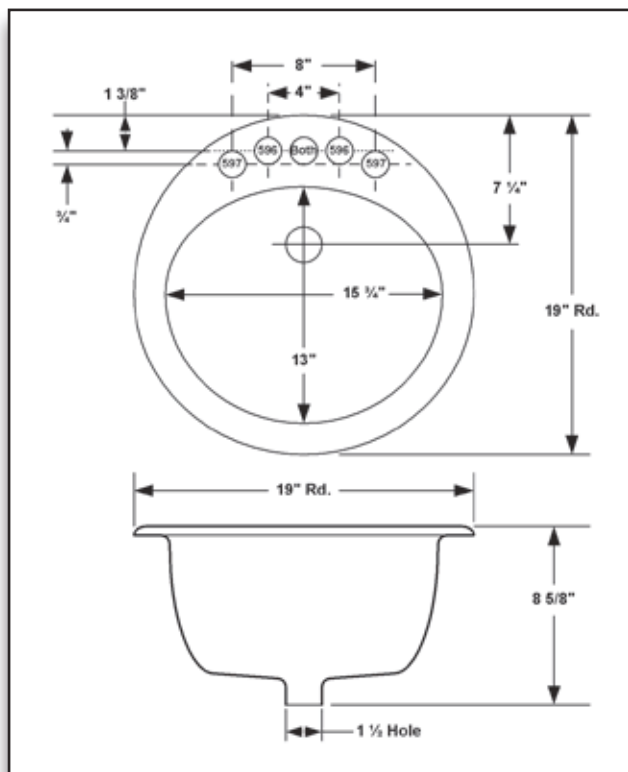

Cat. No.	Size	Center Set	Ship Wt.
596	19"	4"	40 lbs.
597	19"	8"	40 lbs.

ACID RESISTANT ENAMEL ON CAST IRON





# Bar & Entertainment Sinks



1310 E. Borchard Ave. • Santa Ana, CA 92705 • P 714.656.1950 • F 714.656.1969  
[www.cecossinks.com](http://www.cecossinks.com)

**CECO**



# Bar & Entertainment Sinks



1310 E. Borchard Ave. • Santa Ana, CA 92705 • P 714.656.1950 • F 714.656.1969  
[www.cecossinks.com](http://www.cecossinks.com)





## Phoenix

18" Round Vegetable / Entertainment Sink

Available as Self Rimming Sink ( Model # 717) or Undermount Sink ( Model # 717 UM).

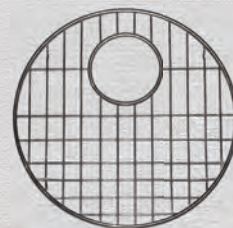
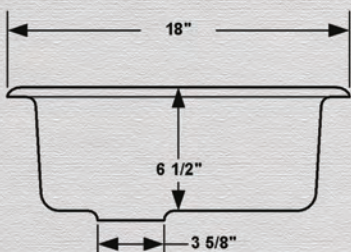
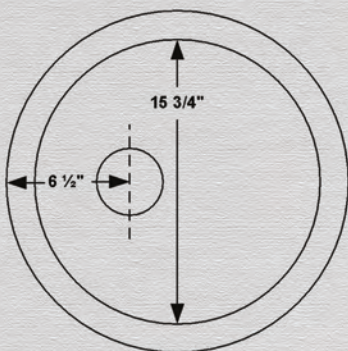

717-STC Sink Tray



717-WCB

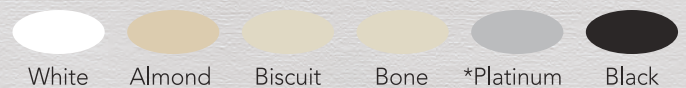



721

# Mojave

16" x 20" Vegetable/Bar Sink  
 Tile, Metal Rim or Undercounter Mount  
 Available in 4" or 8" Center Set  
 3 1/2" Drain

Accessories (Sold Separately)  
 Mounting Rim  
 Cutting Board  
 Sink Tray



Mojave

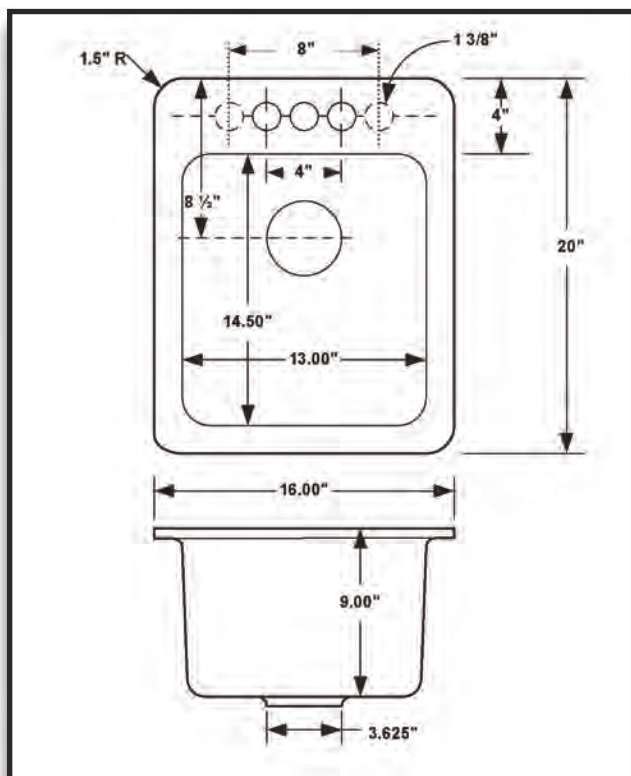

Cat. No.	Size	Depth	Ship Wt.
721-C	16" x 20"	9"	58 lbs

Available with 4" and 8" Center Set

ACID RESISTANT ENAMEL ON CAST IRON

\*Rough-in dimensions may vary 1/4"

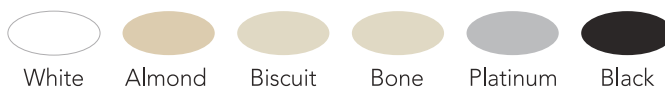

**CECO**

1310 E. Borchard Ave. • Santa Ana, CA 92705 • P 714.656.1950 • F 714.656.1969  
[www.cecossinks.com](http://www.cecossinks.com)



# Indian Wells

722

723

Indian Wells

15" x 15" Bar Sink  
Self Rimming

3 1/2" Drain



Cat. No.	Size	Depth	Ship Wt.
722 (1 Hole)	15" x 15"	7"	30 lbs.
723 (2 Hole)	15" x 15"	7"	30 lbs.

ACID RESISTANT ENAMEL ON CAST IRON

\*Rough-in dimensions may vary 1/4"

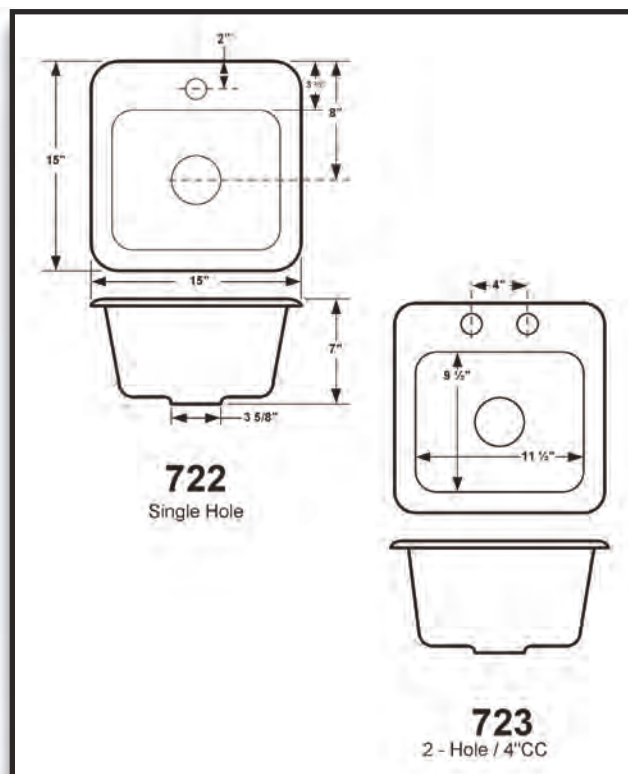

724

# Rancho Mirage

Rancho Mirage

15" x 15" Bar Sink

Tile, Metal Rim or Undercounter Mount

Available in 1 or 2 Hole Drill

3 1/2" Drain

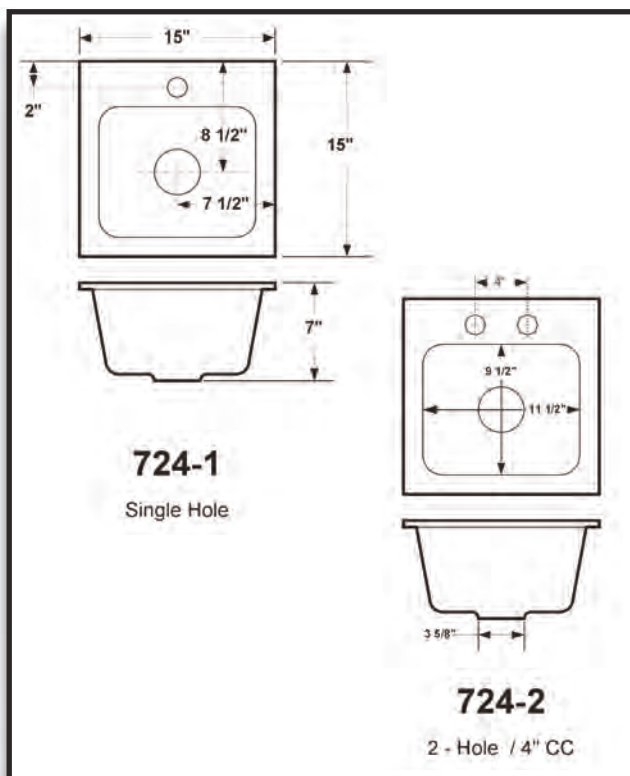

Cat. No.	Size	Depth	Ship Wt.
724-1	15" x 15"	7"	30 lbs.
724-2	15" x 15"	7"	30 lbs.

ACID RESISTANT ENAMEL ON CAST IRON

\*Rough-in dimensions may vary 1/4"

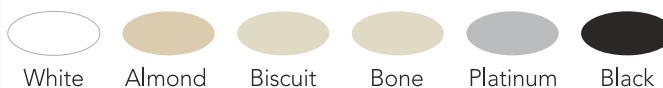

**CECO**

1310 E. Borchard Ave. • Santa Ana, CA 92705 • P 714.656.1950 • F 714.656.1969  
[www.cecossinks.com](http://www.cecossinks.com)



# La Quinta

728  
UM

La Quinta



## La Quinta

16" x 17.5" x 9" Vegetable / Entertainment / Bar Sink  
Undermount Accessory Kit Included



728-WCB

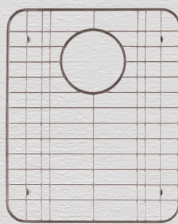

728-STC Sink Tray



White



Almond



Biscuit



Bone



Platinum



Black

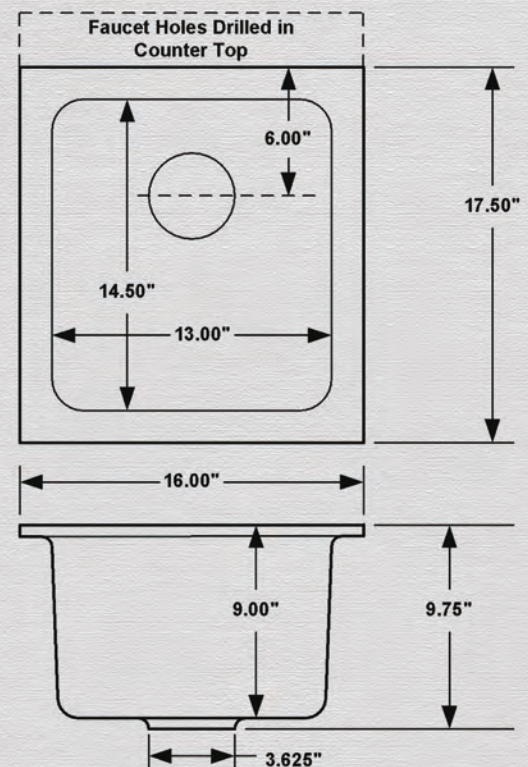

1310 E. Borchard Ave. • Santa Ana, CA 92705 • P 714.656.1950 • F 714.656.1969

[www.cecossinks.com](http://www.cecossinks.com)

**CECO**



# La Quinta

La Quinta

16" x 20" Vegetable/Bar Sink  
Tile-In or Undercounter Mount  
Flat Rim

Available in 4" or 8" Center Set  
1 Hole Center Drill  
3 1/2" Drain

Accessories (Sold Separately)  
Cutting Board  
Sink Tray



Cat. No.	Size	Depth	Ship Wt.
728	16" x 20"	9"	60 lbs.
728-UM	16" x 17 1/2"	9"	60 lbs

\*No Faucet Deck on 728-UM Model

ACID RESISTANT ENAMEL ON CAST IRON

\*Rough-in dimensions may vary 1/4"

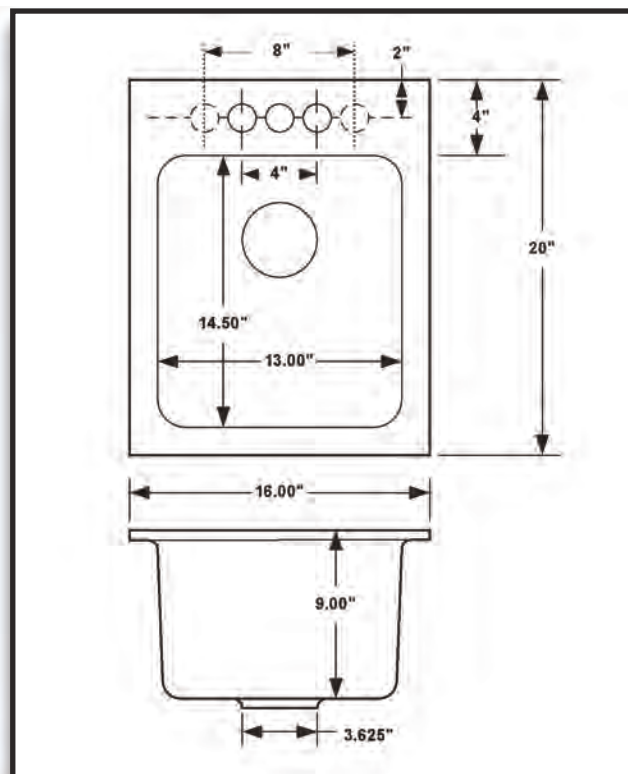
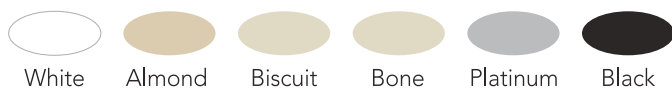





16" x 20" Vegetable/Bar Sink  
Self Rimming

Available in 4" or 8" Center Set  
1 Hole Center Drill  
3 1/2" Drain

Accessories  
(Sold Separately)  
Cutting Board  
Sink Tray

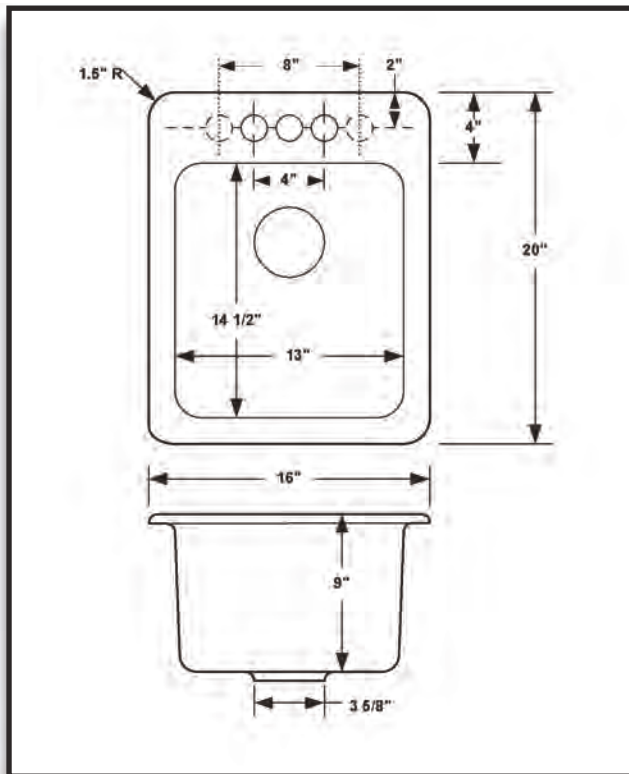

Cat. No.	Size	Depth	Ship Wt.
729	16" x 20"	9"	60 lbs.

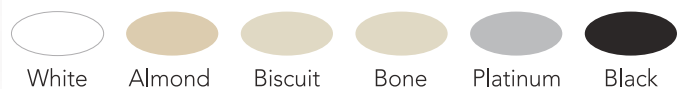



1310 E. Borchard Ave. • Santa Ana, CA 92705 • P 714.656.1950 • F 714.656.1969  
[www.cecosinks.com](http://www.cecosinks.com)



# Kitchen Sinks



1310 E. Borchard Ave. • Santa Ana, CA 92705 • P 714.656.1950 • F 714.656.1969  
[www.cecosinks.com](http://www.cecosinks.com)

**CECO**



# Kitchen Sinks



1310 E. Borchard Ave. • Santa Ana, CA 92705 • P 714.656.1950 • F 714.656.1969  
[www.cecokinks.com](http://www.cecokinks.com)



# Little Corona

720

Little Corona



Flat Rim Kitchen Sink  
Tile-In, Rim Mount or  
Undercounter Mount

Accessories (Sold Separately)  
Mounting Rim

Cat. No.	Size	Specs			Ship Wt.
		A	B	C	
720-F	24" x 16"	24"	16"	6.5"	46 lbs.
720-G	24" x 18"	24"	18"	6.5"	53 lbs.
720-H	24" x 20"	24"	20"	6.5"	57 lbs.
720-I	30" x 18"	30"	18"	7"	65 lbs.
720-J	30" x 20"	30"	20"	7"	70 lbs.

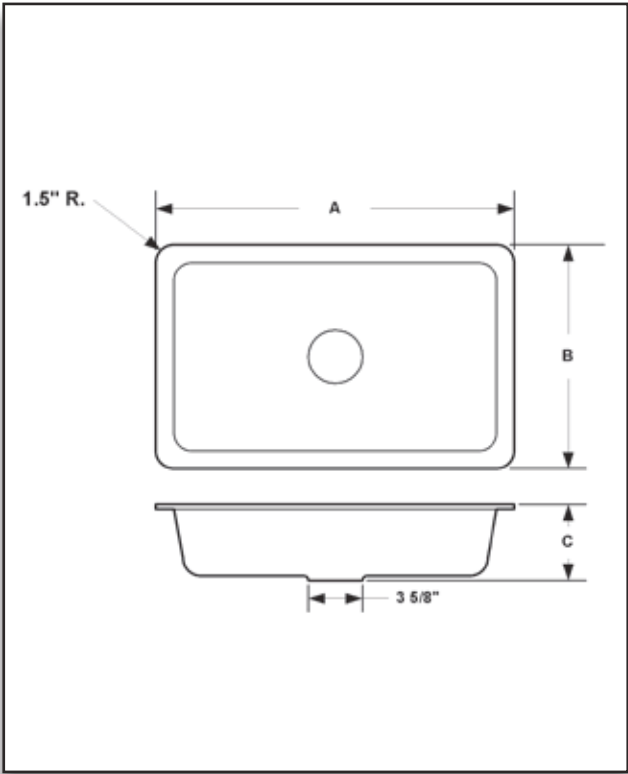

ACID RESISTANT ENAMEL ON CAST IRON  
\*Rough-in dimensions may vary 1/4"

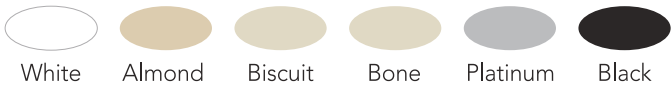

Flat Rim Kitchen Sink  
Rim Mount, Tile-In or Undercounter Mount

Accessories (Sold Separately)  
Mounting Rim

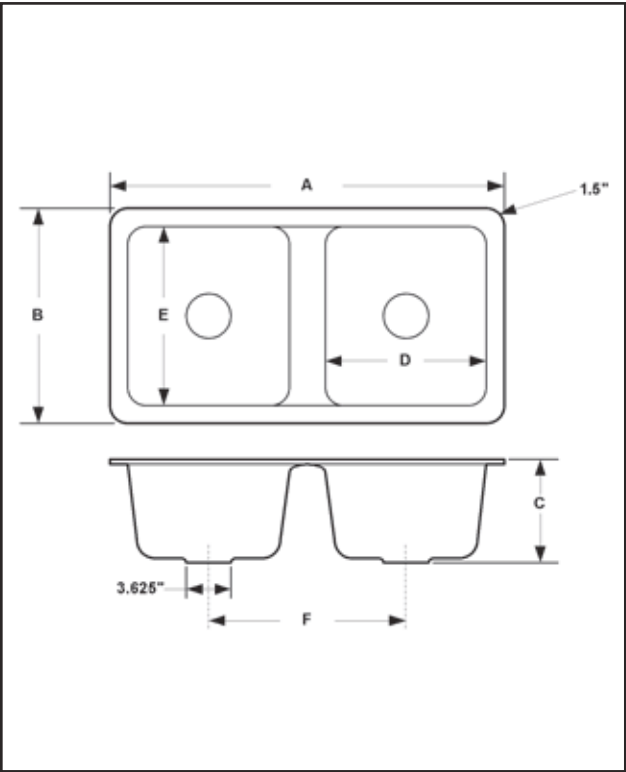

Cat. No.	Size	Specs (inches)						Ship Wt.
		A	B	C	D	E	F	
730-A	30" x 18"	30	18	8.5	12.5	15.5	13	90 lbs.
730-B	30" x 20"	30	20	8.5	12.5	17.5	13	95 lbs.
730-C	32" x 18"	32	18	8.5	13.5	15.5	16	98 lbs.
730-D	32" x 20"	32	20	8.5	13.5	17.5	16	100 lbs.

ACID RESISTANT ENAMEL ON CAST IRON  
\*Rough-in dimensions may vary 1/4"

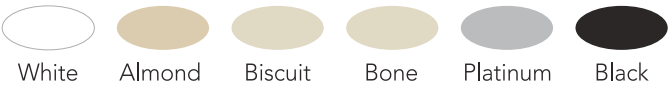



32" x 18" Double Bowl Hi-Low  
Tile-In or Undercounter Mount, Metal Rim

Accessories (Sold Separately)  
Mounting Rim



Manhattan

Cat. No.	Size	Depth	Ship Wt.
732	32" x 18"	8.75"	80 lbs.

ACID RESISTANT ENAMEL ON CAST IRON  
\*Rough-in dimensions may vary 1/4"

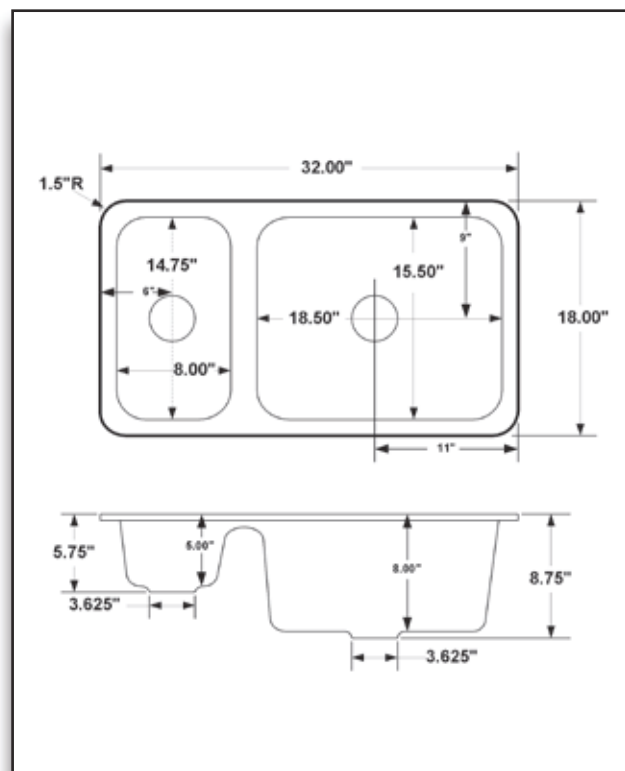
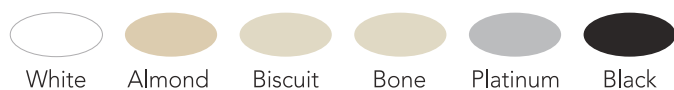



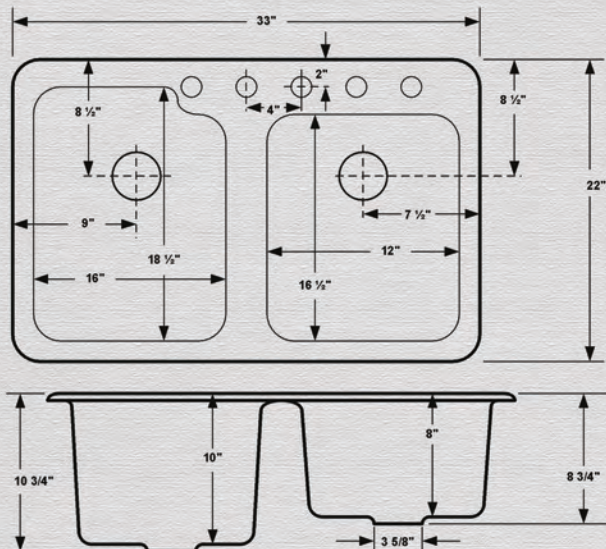

## Redondo

33" x 22" x 10" Left Bowl / 8" Right Bowl  
Offset Self Rimming Kitchen Sink

Available with 4 or 5 Faucet Holes

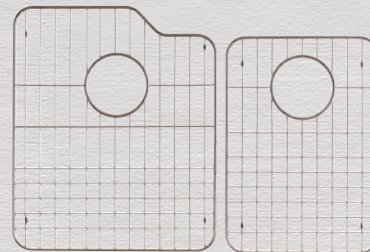

734-STC Sink Tray



734-WCB



White



Almond



Biscuit



Bone



Platinum



Black



# Redondo

735

Redondo



## Redondo

33" x 22" x 10" Left Bowl / 8" Right Bowl  
Offset Tile Edge Kitchen Sink  
Available with 4 or 5 Faucet Holes

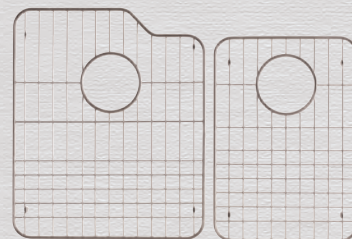
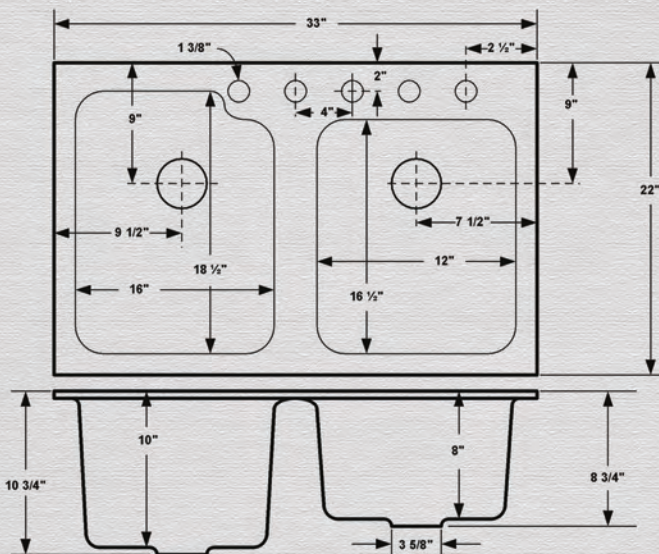

735-4-STC Sink Tray



735-4-WCB



White



Almond



Biscuit



Bone



Platinum



Black

1310 E. Borchard Ave. • Santa Ana, CA 92705 • P 714.656.1950 • F 714.656.1969

[www.cecossinks.com](http://www.cecossinks.com)

# CECO



736

# Huntington

Huntington



## Huntington

36" x 22" x 10" Left Bowl / 8" Right Bowl  
Offset Self Rimming Kitchen Sink  
Available with 4 or 5 Faucet Holes

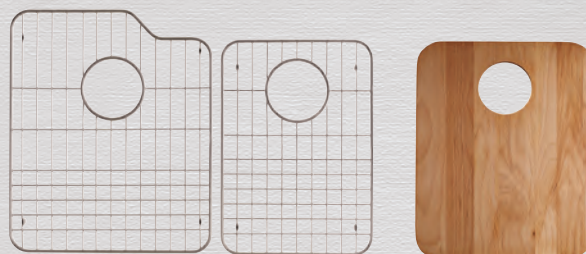
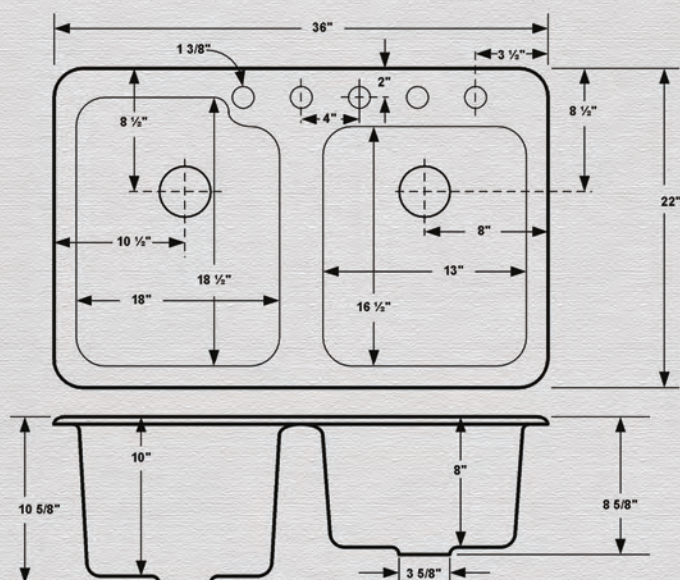

736-STC Sink Tray

736-WCB

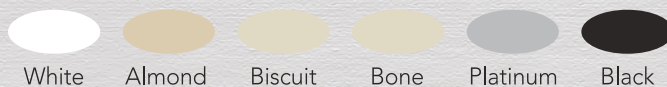

1310 E. Borchard Ave. • Santa Ana, CA 92705 • P 714.656.1950 • F 714.656.1969

[www.cecossinks.com](http://www.cecossinks.com)

**CECO**



# Huntington

737

Huntington



## Huntington

36" x 22" x 10" Left Bowl / 8" Right Bowl  
Offset Tile Edge Kitchen Sink  
Available with 4 or 5 Faucet Holes

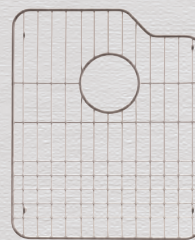
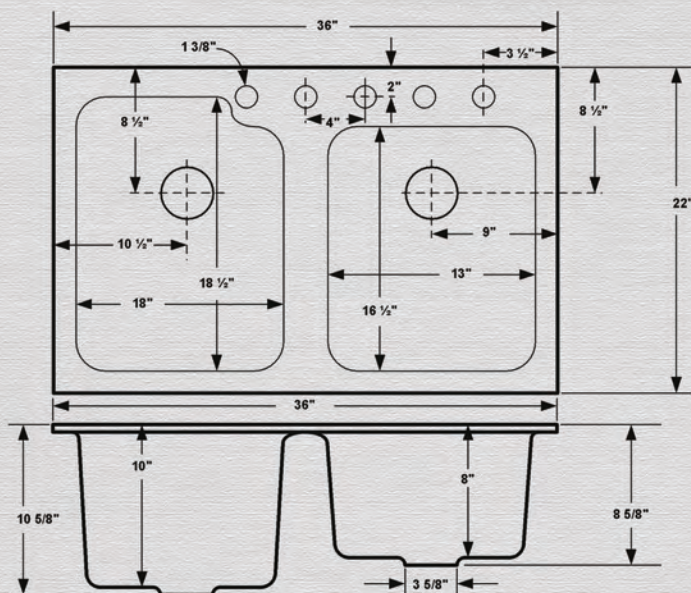

737-4-STC Sink Tray



737-4-WCB



White



Almond



Biscuit



Bone



Platinum



Black

**CECO**

1310 E. Borchard Ave. • Santa Ana, CA 92705 • P 714.656.1950 • F 714.656.1969  
[www.cecossinks.com](http://www.cecossinks.com)



740  
760

# San Clemente

San Clemente

32" x 21" Kitchen Sink  
Tile-In or Undercounter Mount

Accessories (Sold Separately)  
Mounting Rim

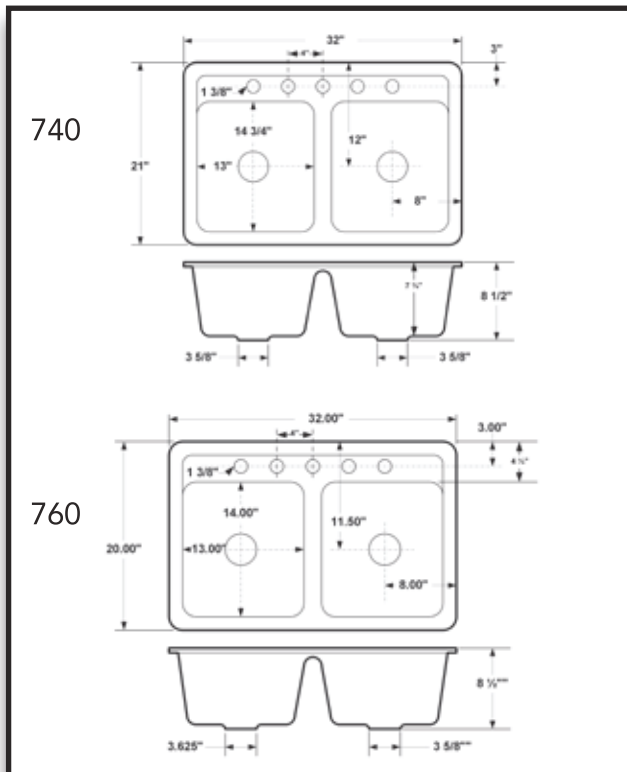

Cat. No.	Size	Depth	Ship Wt.
740	32" x 21"	8"	90 lbs.
760	32" x 20"	8"	90 lbs.

ACID RESISTANT ENAMEL ON CAST IRON  
\*Rough-in dimensions may vary 1/4"

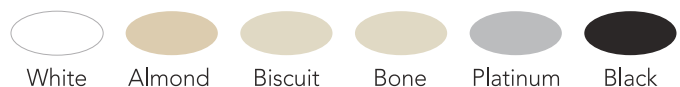

**CECO**

1310 E. Borchard Ave. • Santa Ana, CA 92705 • P 714.656.1950 • F 714.656.1969  
[www.cecokinks.com](http://www.cecokinks.com)



# Big Corona

743

Big Corona



## Big Corona

43" x 22" x 10" Double Bowl Self Rimming Kitchen Sink  
Available with 4 or 5 Faucet Holes



743-WCB

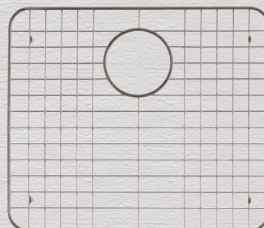

743-STC Sink Tray

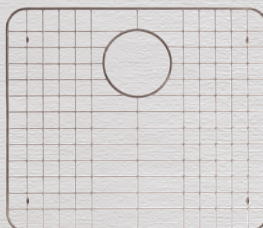

White



Almond



Biscuit

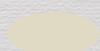

Bone



Platinum



Black

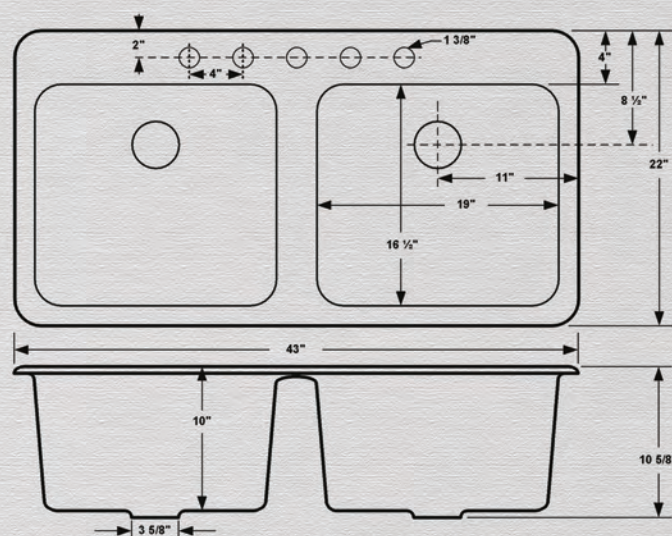

**CECO**

1310 E. Borchard Ave. • Santa Ana, CA 92705 • P 714.656.1950 • F 714.656.1969  
[www.cecokinks.com](http://www.cecokinks.com)



744

# Big Corona

Big Corona



## Big Corona

43" x 22" x 10" Double Bowl Tile Edge Kitchen Sink

Available with 4 or 5 Faucet Holes



744-WCB

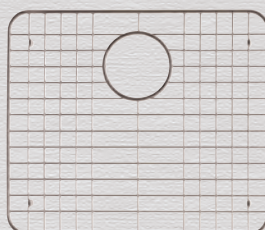

744-STC Sink Tray

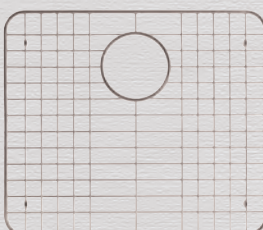

White



Almond



Biscuit



Bone



Platinum



Black

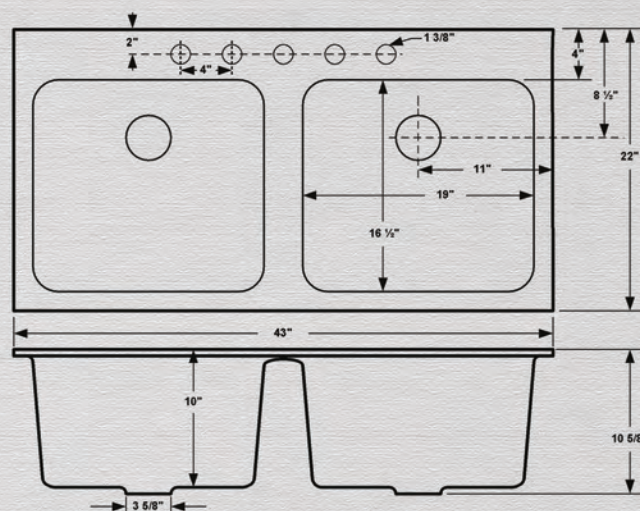

**CECO**

1310 E. Borchard Ave. • Santa Ana, CA 92705 • P 714.656.1950 • F 714.656.1969  
[www.cecokinks.com](http://www.cecokinks.com)



# Royal Palm

745

Royal Palm



## Royal Palm

33" x 22" x 10" Equal Double Bowl  
Self Rimming Kitchen Sink  
Available with 4 or 5 Faucet Holes



745-WCB

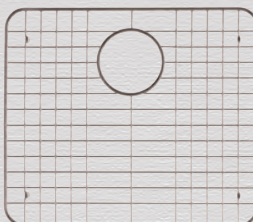

745-STC Sink Tray

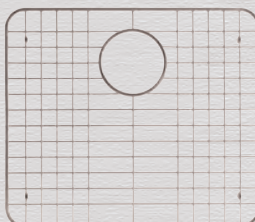

White



Almond



Biscuit



Bone



Platinum



Black

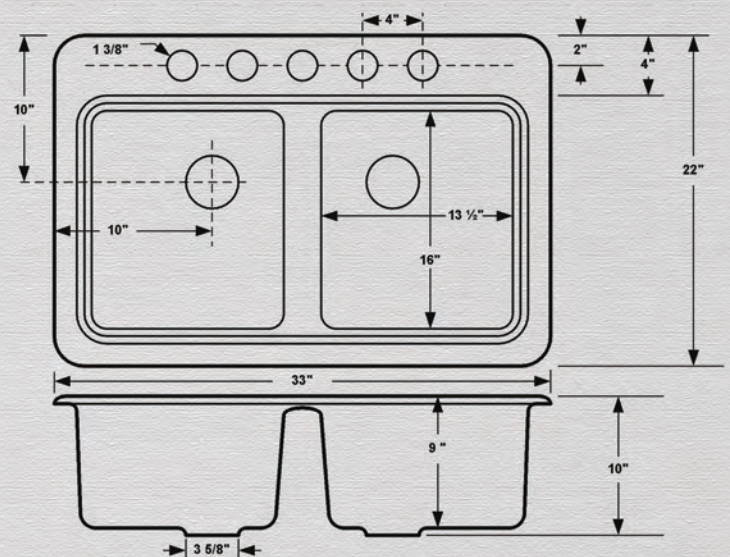

1310 E. Borchard Ave. • Santa Ana, CA 92705 • P 714.656.1950 • F 714.656.1969

[www.cecossinks.com](http://www.cecossinks.com)

**CECO**



747

# Doheny

Doheny



## D o h e n y

33" x 22" x 9" Equal Double Bowl  
Self Rimming Kitchen Sink

Available with 4 or 5 Faucet Holes



747-WCB

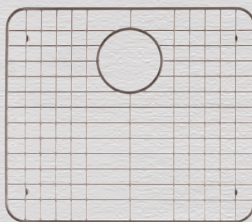

747-STC Sink Tray

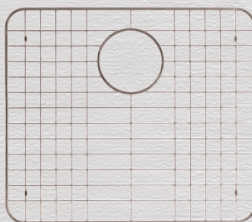

White



Almond



Biscuit



Bone



Platinum



Black

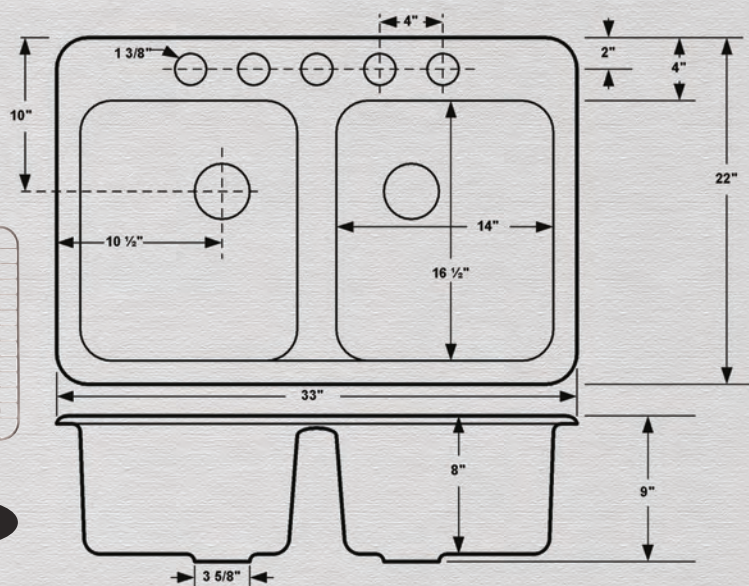

1310 E. Borchard Ave. • Santa Ana, CA 92705 • P 714.656.1950 • F 714.656.1969

[www.cecocosinks.com](http://www.cecocosinks.com)

# CECO





## Doheny

33" x 22" x 9" Double Bowl Tile Edge Kitchen Sink

Available with 4 or 5 Faucet Holes



748-WCB

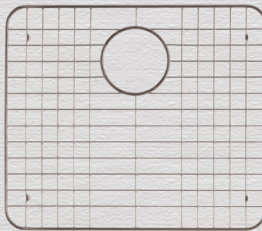

748-STC Sink Tray



White

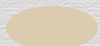

Almond

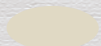

Biscuit

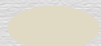

Bone



Platinum



Black

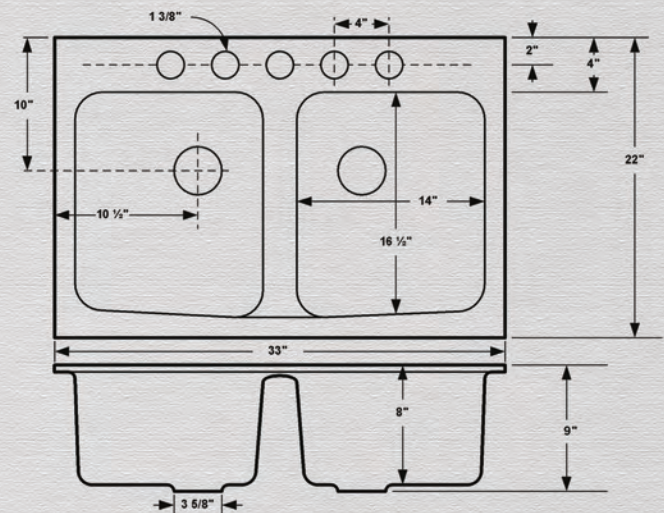



750

# Seaside

24" x 21" Kitchen Sink  
Flat Rim  
Tile-In or Undercounter Mount

Accessories (Sold Separately)  
Mounting Rim



Seaside

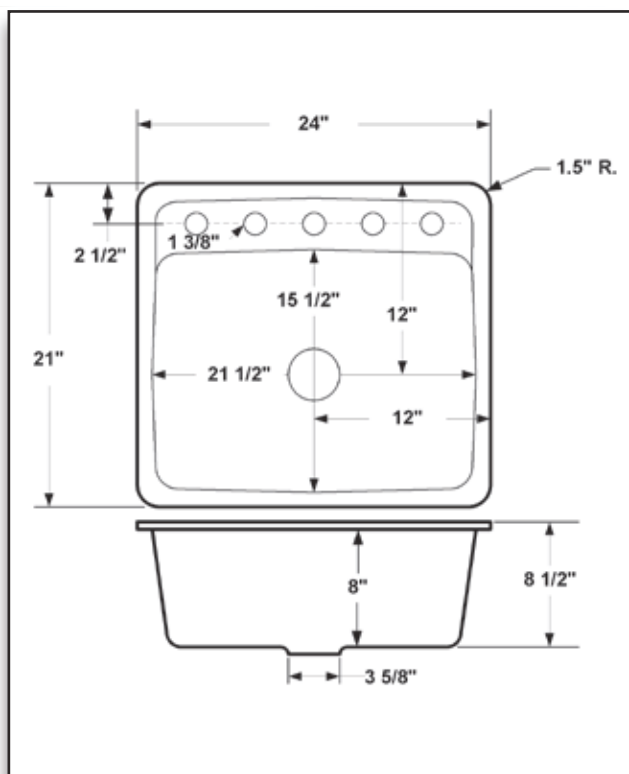

Cat. No.	Size	Depth	Ship Wt.
750	24" x 21"	8"	78 lbs.

ACID RESISTANT ENAMEL ON CAST IRON  
\*Rough-in dimensions may vary 1/4"

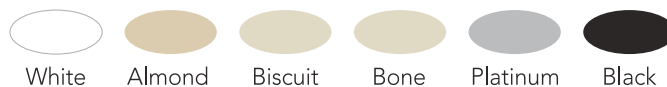
**CECO**

1310 E. Borchard Ave. • Santa Ana, CA 92705 • P 714.656.1950 • F 714.656.1969  
[www.cecossinks.com](http://www.cecossinks.com)





## Delray

33" x 22" x 9" Single Bowl Self Rimming Kitchen Sink  
Available with 4 or 5 Faucet Holes



753-WCB

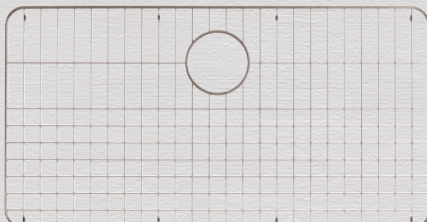

753-STC Sink Tray



White



Almond



Biscuit



Bone



Platinum



Black

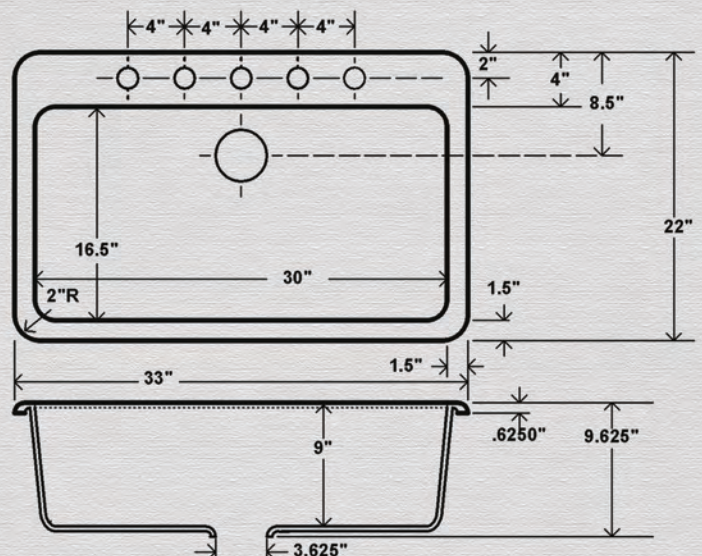



754

# Delray

Delray

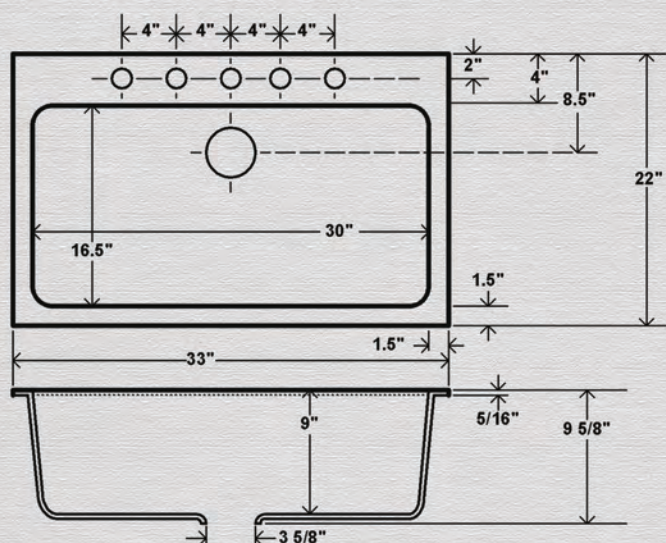

## Delray

33" x 22" x 9" Single Bowl Tile Edge Kitchen Sink

Available with 4 or 5 Faucet Holes

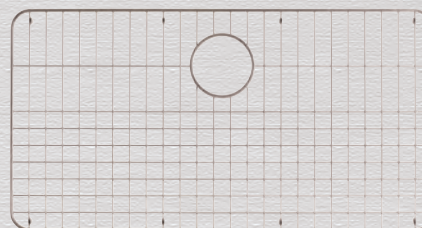

754-STC Sink Tray



754-WCB

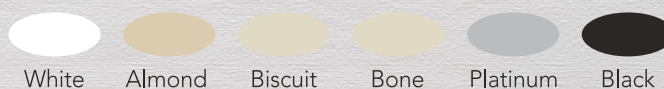

### CECO

1310 E. Borchard Ave. • Santa Ana, CA 92705 • P 714.656.1950 • F 714.656.1969  
[www.cecosinks.com](http://www.cecosinks.com)



25" x 22" Kitchen Sink  
Self Rimming

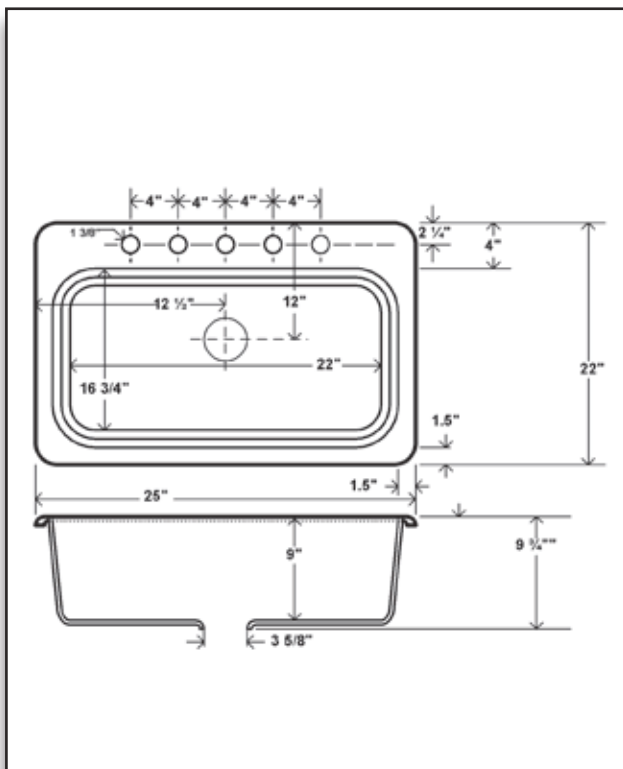

Cat. No.	Size	Depth	Ship Wt.
757	25" x 22"	9 3/4"	68 lbs.

ACID RESISTANT ENAMEL ON CAST IRON  
\*Rough-in dimensions may vary 1/4"

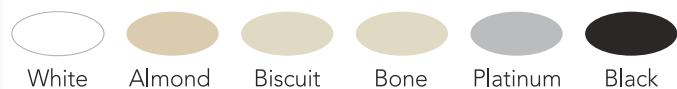



767

# Dockweiler

Dockweiler

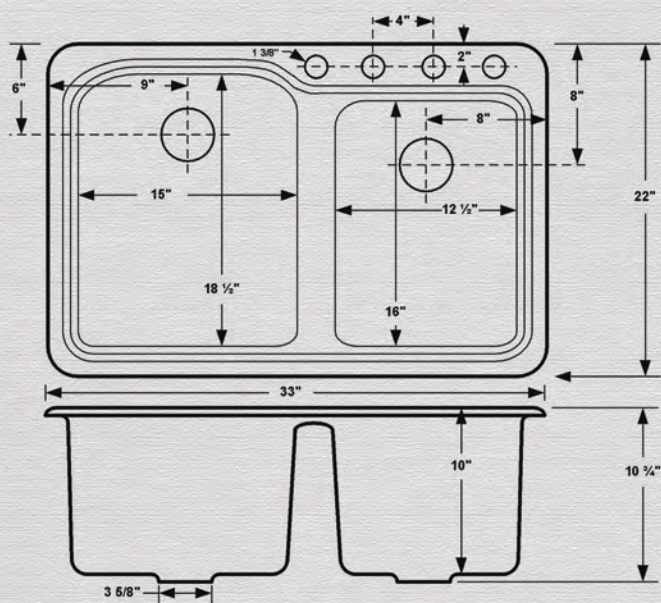

## Dockweiler

33" x 22" x 10.75" Offset Double Bowl  
Self Rimming Kitchen Sink  
Available with 4 Faucet Holes

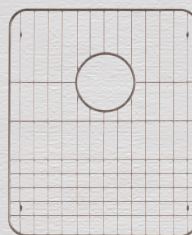

767-STC Sink Tray



767-WCB



White



Almond



Biscuit



Bone



Platinum



Black

### CECO

1310 E. Borchard Ave. • Santa Ana, CA 92705 • P 714.656.1950 • F 714.656.1969  
[www.cecokinks.com](http://www.cecokinks.com)





## Dockweiler

33" x 22" x 10.75" Offset Double Bowl Tile Edge Kitchen Sink  
Available with 4 Faucet Holes



768-WCB

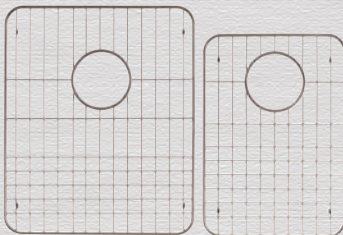

768-STC Sink Tray



White



Almond



Biscuit

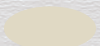

Bone



Platinum



Black

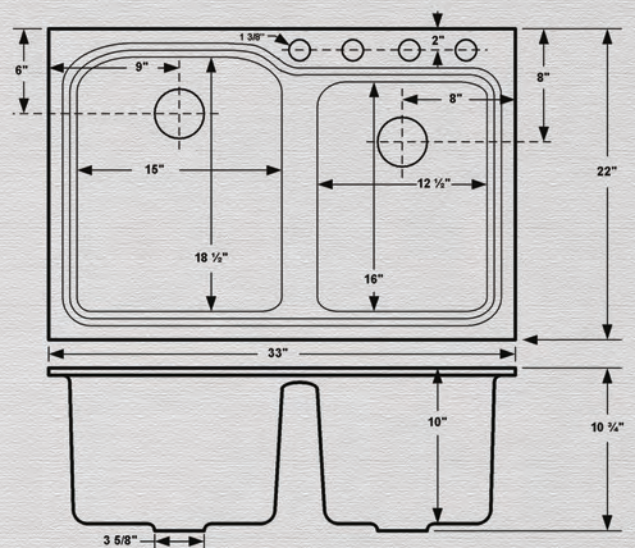



770

Zuma

32" x 21" Kitchen Sink  
Flat Rim  
Tile-In or Undercounter Mount

Accessories (Sold Separately)  
Mounting Rim

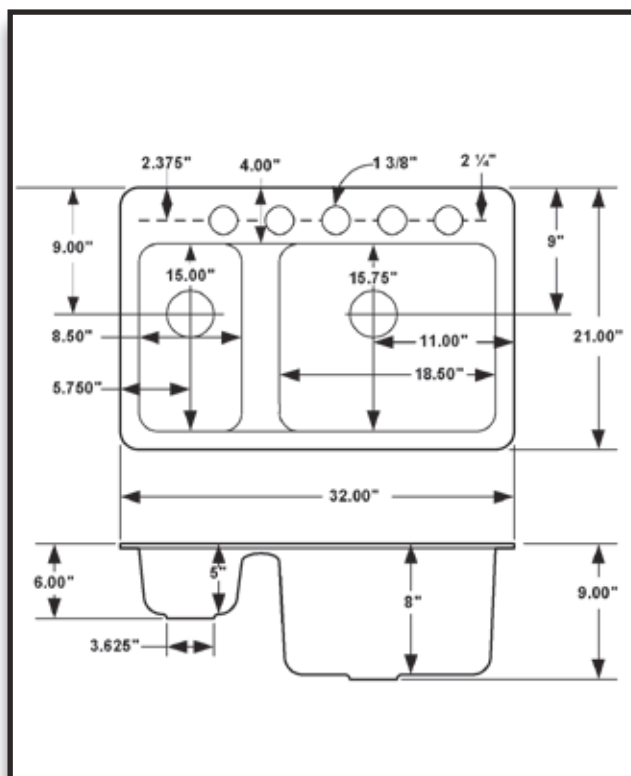

Cat. No.	Size	Depth	Ship Wt.
770	32" x 21"	9"	90 lbs.

ACID RESISTANT ENAMEL ON CAST IRON  
\*Rough-in dimensions may vary 1/4"

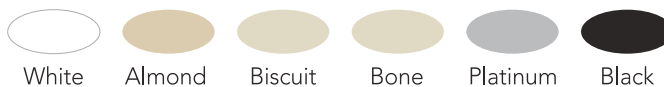

CECO

1310 E. Borchard Ave. • Santa Ana, CA 92705 • P 714.656.1950 • F 714.656.1969  
[www.cecossinks.com](http://www.cecossinks.com)

Zuma



# Windansea

775  
LD

Windansea



## Windansea

33" x 22" x 9.75" Offset Low Damn Self Rimming Kitchen Sink  
Available with 4 Faucet Holes



775-WCB

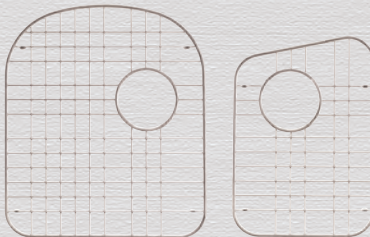

775-STC Sink Tray



White



Almond



Biscuit



Bone



Platinum



Black

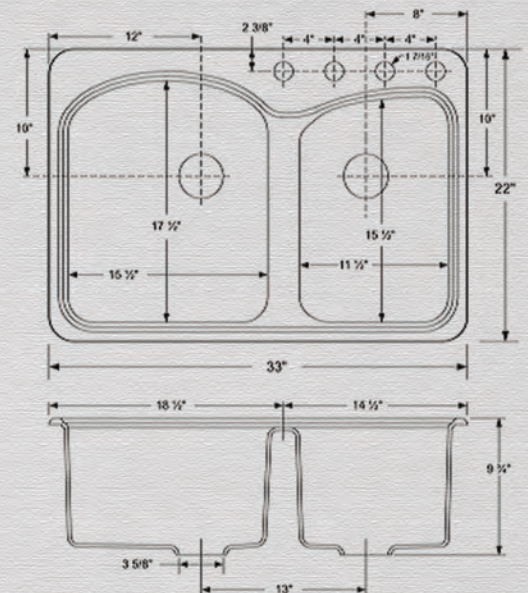

1310 E. Borchard Ave. • Santa Ana, CA 92705 • P 714.656.1950 • F 714.656.1969

[www.cecossinks.com](http://www.cecossinks.com)

**CECO**



33" x 22" Kitchen Sink  
Self Rimming

Laguna



Cat. No.	Size	Depth	Ship Wt.
777	33" x 22"	9"	90 lbs.

ACID RESISTANT ENAMEL ON CAST IRON  
\*Rough-in dimensions may vary 1/4"

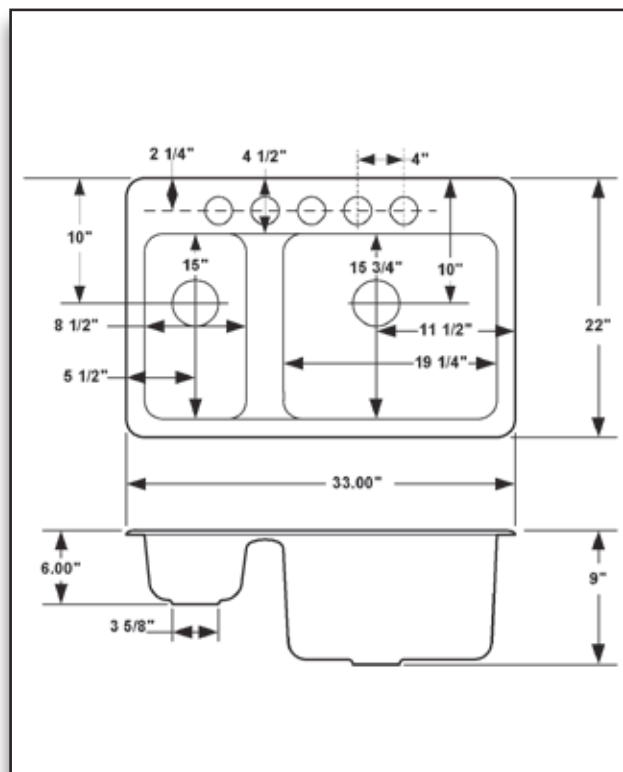



# Hermosa

784  
785

Hermosa



33" x 22"  
Tile-In or Undercounter Mount

Accessories (Sold Separately)  
Cutting Boards  
Sink Trays

Cat. No.	Size	Depth	Ship Wt.
784	33" x 22"	7 1/2"	110 lbs.
785	33" x 22"	7 1/2"	110 lbs.

ACID RESISTANT ENAMEL ON CAST IRON  
\*Rough-in dimensions may vary 1/4"

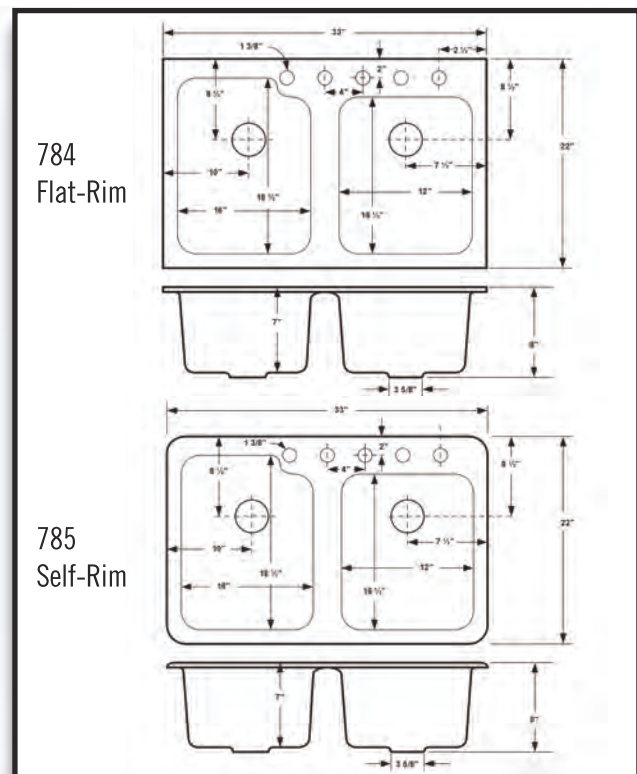
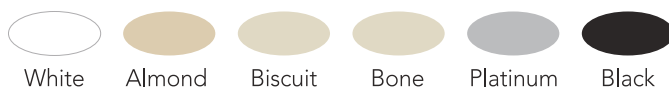

1310 E. Borchard Ave. • Santa Ana, CA 92705 • P 714.656.1950 • F 714.656.1969

[www.cecossinks.com](http://www.cecossinks.com)

**CECO**



797

# Bolsa Chica

43" x 22" Kitchen Sink  
Self Rimming

Bolsa Chica



Cat. No.	Size	Depth	Ship Wt.
797	43" x 22"	8"	140 lbs.

ACID RESISTANT ENAMEL ON CAST IRON  
\*Rough-in dimensions may vary 1/4"

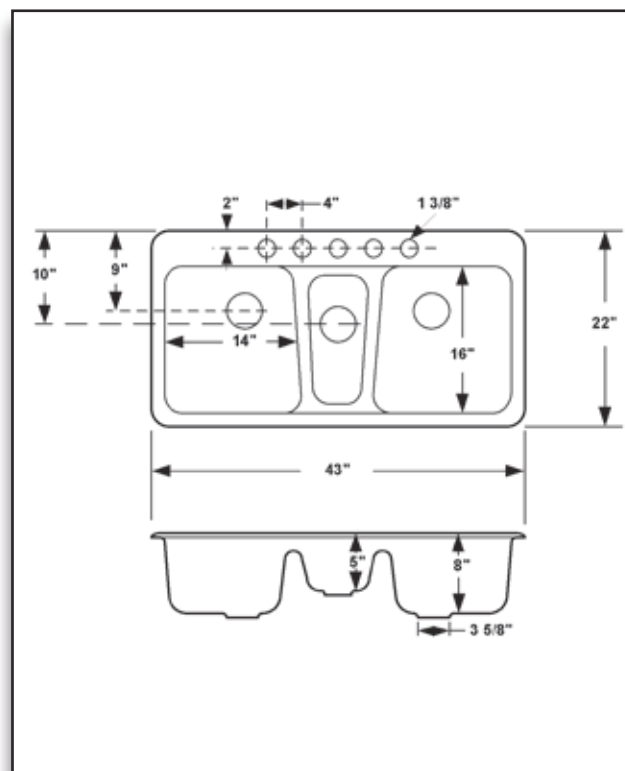
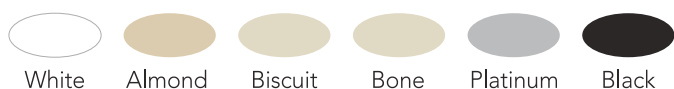



42" x 21" Kitchen Sink  
Tile-In or Undercounter Mount



Northshore

Cat. No.	Size	Depth	Ship Wt.
798	42" x 21"	8"	140 lbs.

ACID RESISTANT ENAMEL ON CAST IRON  
\*Rough-in dimensions may vary 1/4"

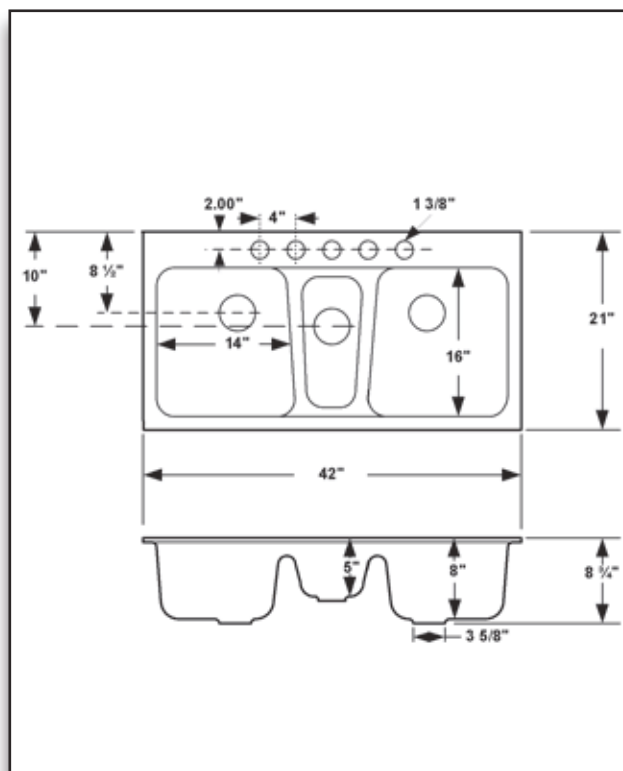





1310 E. Borchard Ave. • Santa Ana, CA 92705 • P 714.656.1950 • F 714.656.1969  
[www.cecossinks.com](http://www.cecossinks.com)



# Sink Trays

## SINK TRAYS

Available for Most Models. All of the above are available in White Vinyl or Chrome Finish



Single Tray Square

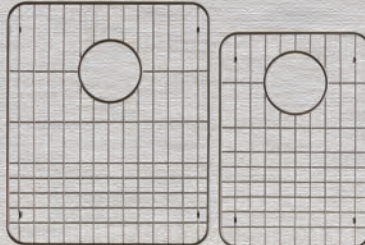

Offset Double Bowl  
Square Corners

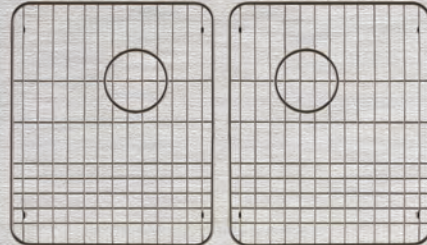

Double Bowl Square  
Offset Holes

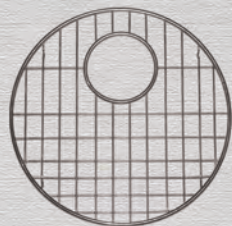

Single Round Bar

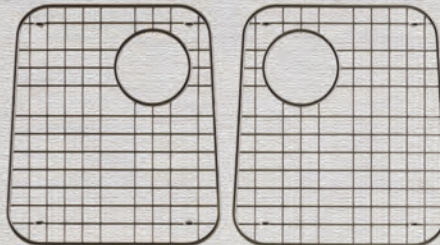

Double Bowls Slanted  
Offset Holes

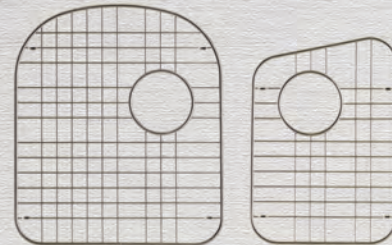

902 DOffset Double Bowl  
Round Slanted

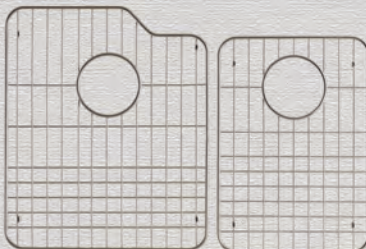

Offset Double Bowl Square

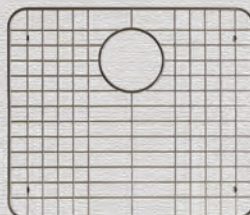

Single Square Bar

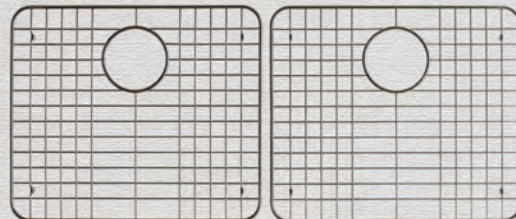

Double Bowl Square

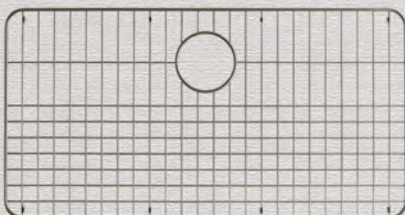

Single Bowl Horizontal

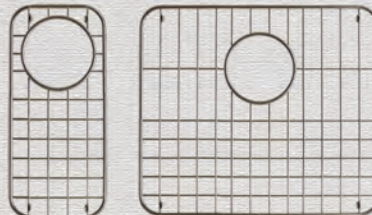

Triple Bowl Square  
w / Vegetable Island

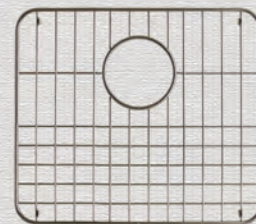

Single Bowl  
Square Corners

Sink Trays



# Cutting Boards

## WOOD CUTTING BOARDS

Available for Most Models

Cutting Boards



Single Tray Square



Offset Double Bowl Square  
Square Corners



Double Bowl Square  
Offset Holes



Single Round Bar



Double Bowls Slanted  
Offset Holes



902 DOffset Double Bowl  
Round Slanted



Offset Double  
Bowl Square



Single Square Bar



Single Square Center Hole

**CECO**

1310 E. Borchard Ave. • Santa Ana, CA 92705 • P 714.656.1950 • F 714.656.1969  
[www.cecocosinks.com](http://www.cecocosinks.com)



# Undermounts



1310 E. Borchard Ave. • Santa Ana, CA 92705 • P 714.656.1950 • F 714.656.1969  
[www.cecossinks.com](http://www.cecossinks.com)

**CECO**



# Undermounts



1310 E. Borchard Ave. • Santa Ana, CA 92705 • P 714.656.1950 • F 714.656.1969  
[www.cecossinks.com](http://www.cecossinks.com)



# Leilani

755  
UM  
FS

Leilani

Overall Size: 33.5" X 20" X 9.5"  
Right / Left Side apron is 6" front to back  
Bowl Size: 30" x 16" x 9.5"

Center of Drain from back wall: 6.5"  
3 1/2" Drain

Material:  
Enameled Cast Iron

Shipping Weight:  
150 lbs.

Accessories  
(Sold Separately):  
Sink Tray

ACID RESISTANT ENAMEL  
ON CAST IRON  
Rough-in dimensions  
may vary 1/4"



755-UM-FS  
(White Shown)

Undermount Accessory  
Kit Included

## Leilani

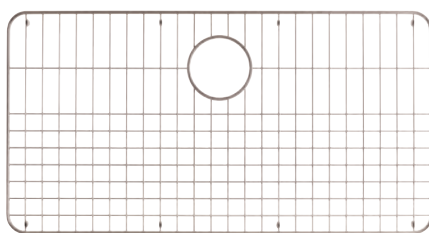

755-UM-FS STC Sink Tray



White

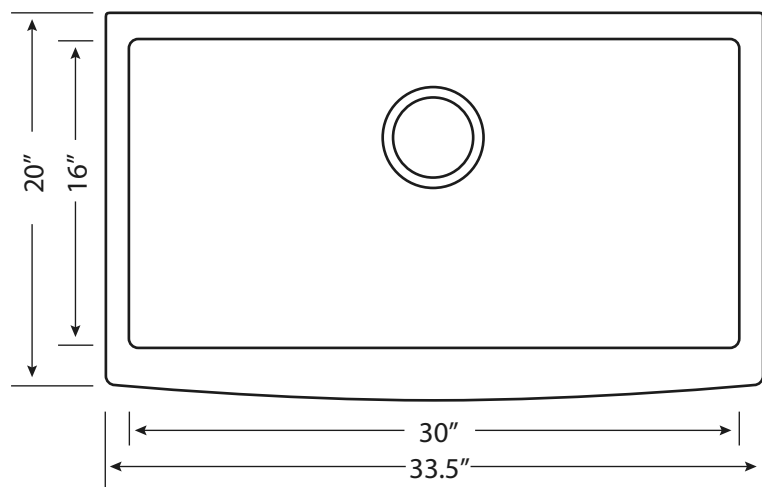

### CECO

1310 E. Borchard Ave. • Santa Ana, CA 92705 • P 714.656.1950 • F 714.656.1969  
[www.cecocosinks.com](http://www.cecocosinks.com)



763  
UM  
FS

Marano

# Marano

Overall Size: 33.5" x 20"  
(edge of Sink, 23.5" at center) x 9.5 Deep

Right/Left side apron is 6" front to back

Big Bowl: Right to Left  
17.5" x 16" front to back

Small Bowl: Right to  
Left 10" x 16" front to  
back

Middle Divider: 4"  
Center of Drain from  
back wall: 6.5"

Undermount Accessory  
Kit Included



763-UM-FS  
(White Shown)

## Marano

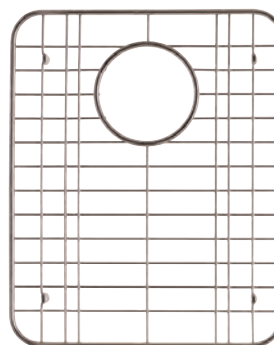
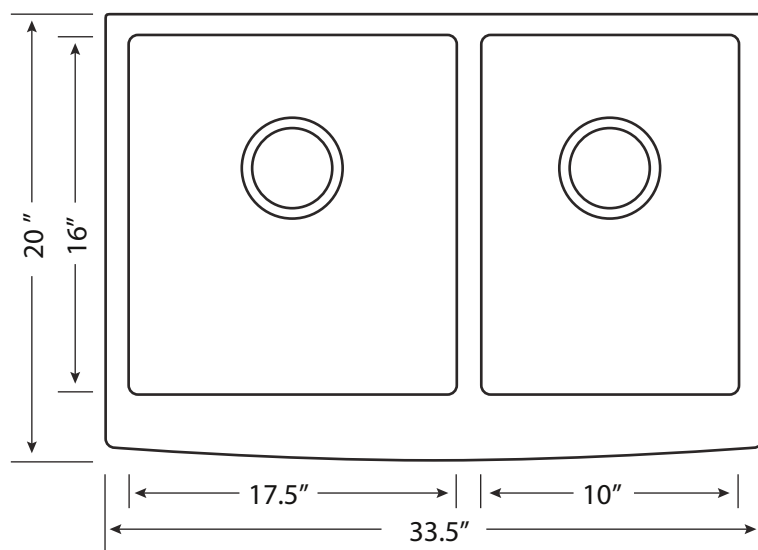

763-UM-FS STC Sink Tray



White

**CECO**

1310 E. Borchard Ave. • Santa Ana, CA 92705 • P 714.656.1950 • F 714.656.1969  
[www.cecossinks.com](http://www.cecossinks.com)



# La Quinta

728  
UM

La Quinta



## La Quinta

16" x 17.5" x 9" Vegetable / Entertainment / Bar Sink  
Undermount Accessory Kit Included



728-WCB

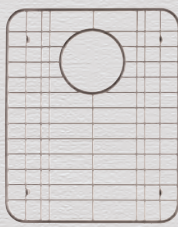

728-STC Sink Tray



White



Almond



Biscuit



Bone



Platinum



Black

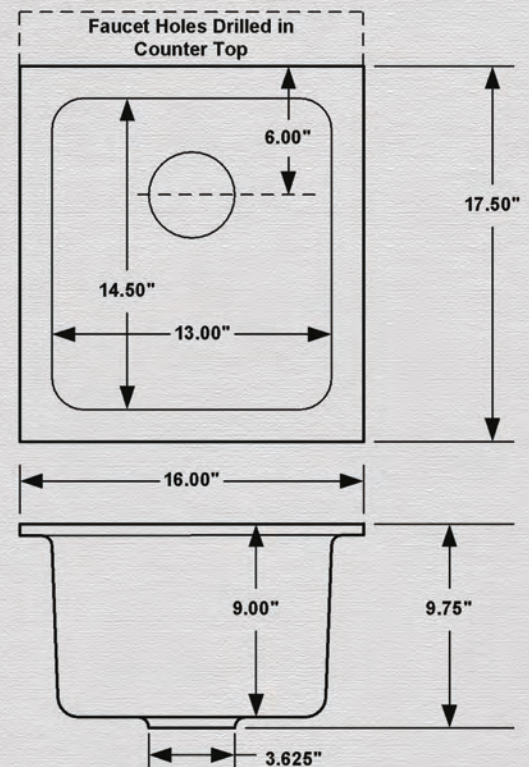

**CECO**

1310 E. Borchard Ave. • Santa Ana, CA 92705 • P 714.656.1950 • F 714.656.1969  
[www.cecossinks.com](http://www.cecossinks.com)



730  
UM

# Aliso

Flat Rim Kitchen Sink  
Undercounter Mount  
Includes UM 25 Mounting Kit

Aliso



Cat. No.	Size	Specs (inches)						Ship Wt.
		A	B	C	D	E	F	
730-A	30" x 18"	30	18	8.5	12.5	15.5	13	90 lbs.
730-B	30" x 20"	30	20	8.5	12.5	17.5	13	95 lbs.
730-C	32" x 18"	32	18	8.5	13.5	15.5	16	98 lbs.
730-D	32" x 20"	32	20	8.5	13.5	17.5	16	100 lbs.

ACID RESISTANT ENAMEL ON CAST IRON  
\*Rough-in dimensions may vary 1/4"

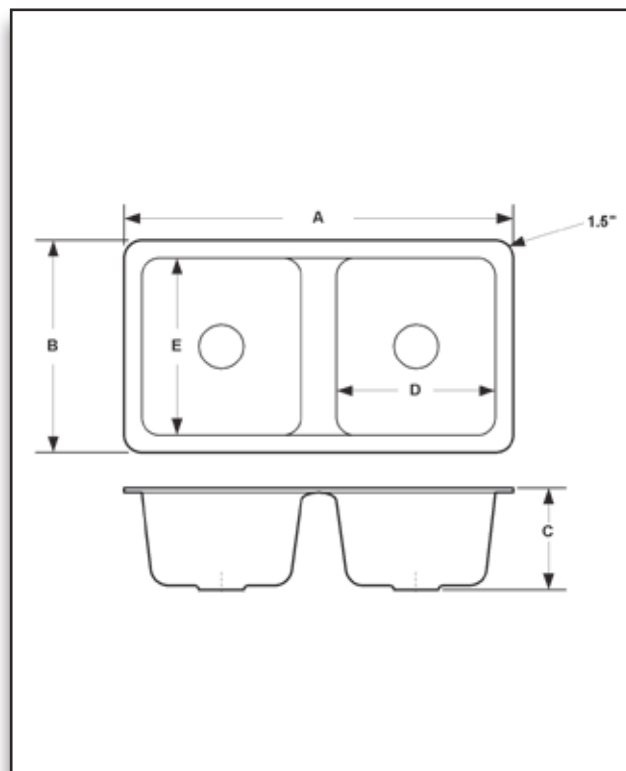
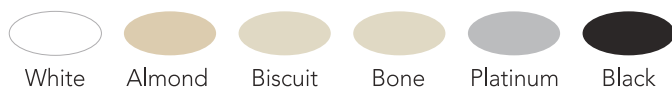

1310 E. Borchard Ave. • Santa Ana, CA 92705 • P 714.656.1950 • F 714.656.1969

[www.cecosinks.com](http://www.cecosinks.com)

**CECO**



Flat Rim Kitchen Sink  
Undercounter Mount  
Includes UM-25 Mounting Kit

Accessories (Sold Separately)  
Cutting Board  
Sink Tray



Cat. No.	Size	Depth	Ship Wt.
732 UM	32" x 18"	8.75"	80 lbs.

ACID RESISTANT ENAMEL ON CAST IRON  
\*Rough-in dimensions may vary 1/4"

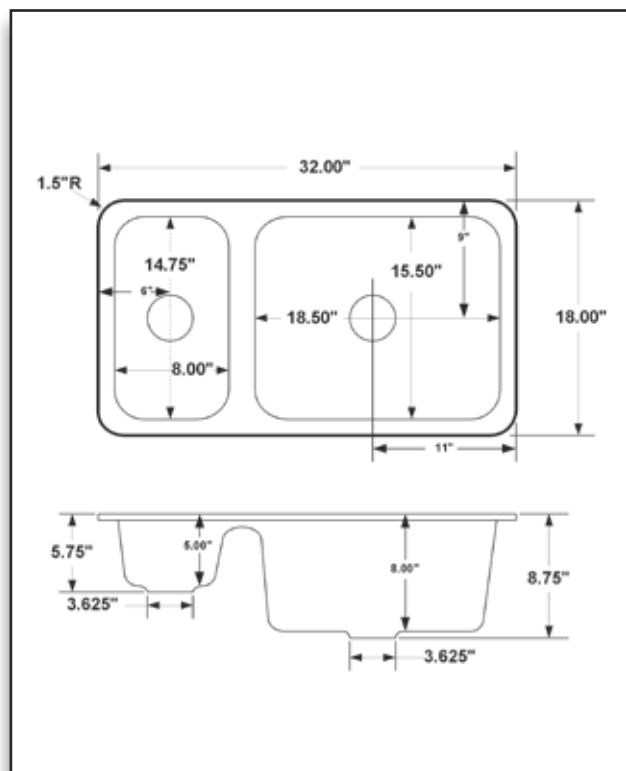
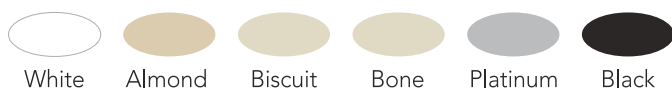



735  
UM

# Redondo

Redondo



## Redondo

33" x 22" x 10" Left Bowl / 8" Right Bowl  
Offset Undermount Kitchen Sink  
Undermount Accessory Kit Included

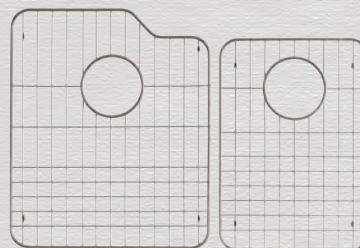
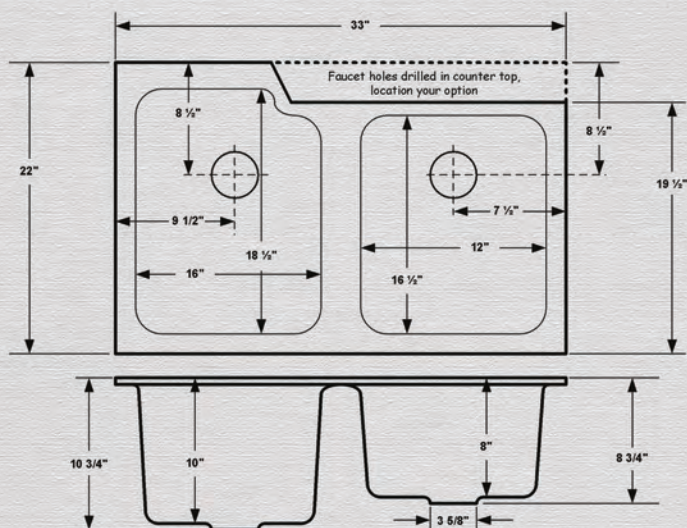

735-STC Sink Tray



735-WCB



White



Almond



Biscuit



Bone



Platinum



Black

**CECO**

1310 E. Borchard Ave. • Santa Ana, CA 92705 • P 714.656.1950 • F 714.656.1969  
[www.cecosinks.com](http://www.cecosinks.com)



# Huntington

737  
UM

Huntington

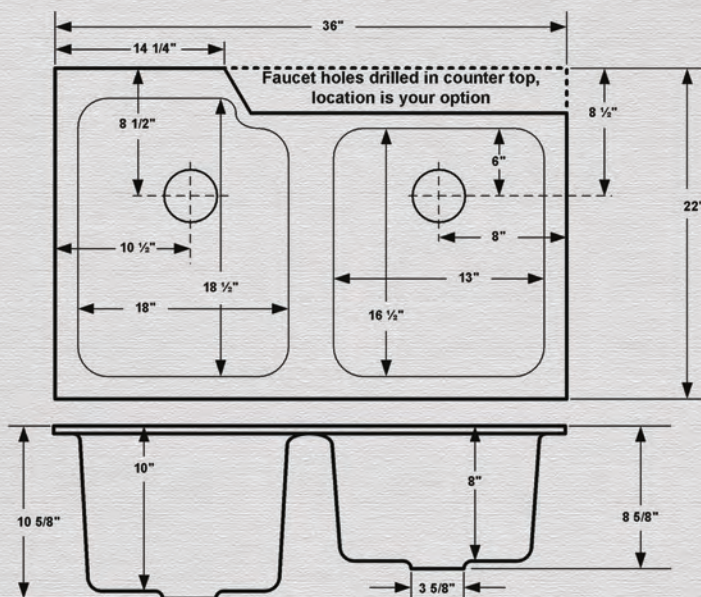

## Huntington

36" x 22" x 10" Left Bowl / 8" Right Bowl  
Offset Undermount Kitchen Sink  
Undermount Accessory Kit Included

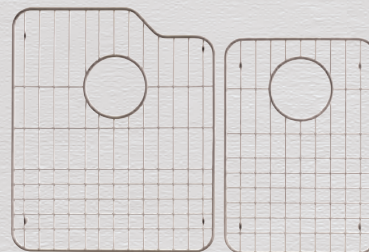

737-STC Sink Tray



737-WCB



White



Almond



Biscuit



Bone



Platinum



Black

1310 E. Borchard Ave. • Santa Ana, CA 92705 • P 714.656.1950 • F 714.656.1969

[www.cecossinks.com](http://www.cecossinks.com)

**CECO**



741  
UM

# Vilano

Vilano



## Vilano

43" x 19.5" x 10" Single Bowl  
Undermount Kitchen Sink  
Undermount Accessory Kit Included



741-WCB

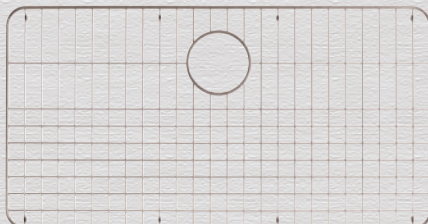

741-STC Sink Tray

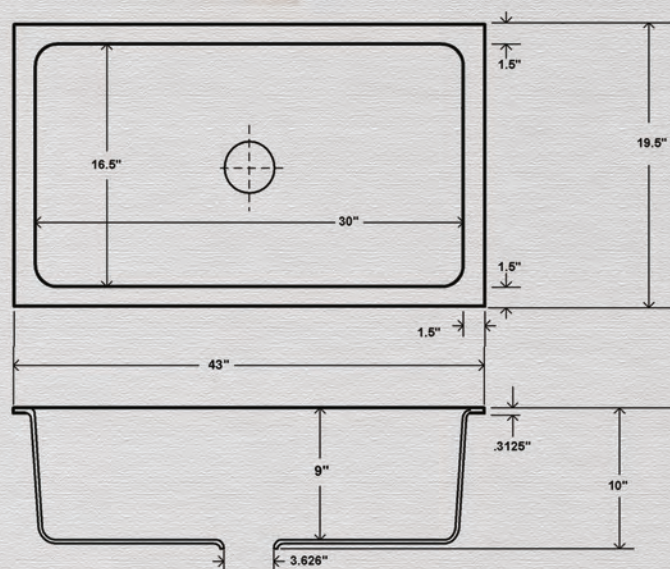
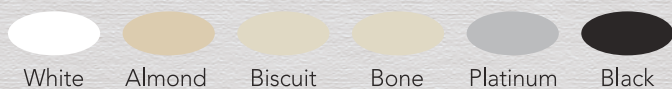

1310 E. Borchard Ave. • Santa Ana, CA 92705 • P 714.656.1950 • F 714.656.1969

[www.cecokinks.com](http://www.cecokinks.com)

# CECO



744  
UM

# Big Corona

[illegible]

744-WCB



White Almond Biscuit Bone Platinum Black

1310 E. Borchard Ave. • Santa Ana, CA 92705 • P 714.656.1950 • F 714.656.1969  
[www.cecosinks.com](http://www.cecosinks.com)

**CECO**



744  
LD  
UM

Big Corona

# Big Corona



## Big Corona

43" x 19.5" x 10" Double Bowl  
Undermount Kitchen Sink  
Undermount Accessory Kit Included

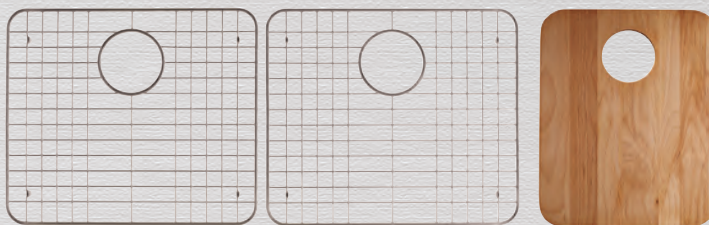
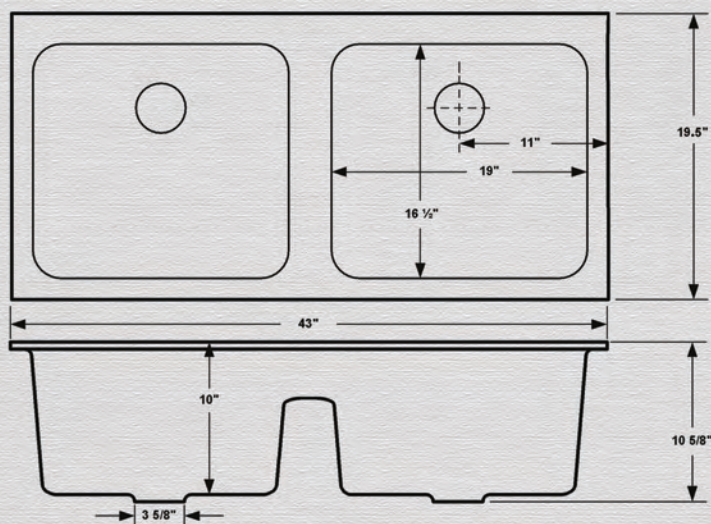

744-STC Sink Tray

744-WCB

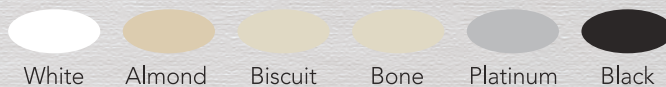

**CECO**

1310 E. Borchard Ave. • Santa Ana, CA 92705 • P 714.656.1950 • F 714.656.1969  
[www.cecokinks.com](http://www.cecokinks.com)



# Royal Palm

746  
UM

Royal Palm



## Royal Palm

33" x 22" x 9.75" Double Bowl  
Undermount Kitchen Sink  
Undermount Accessory Kit Included



746-WCB

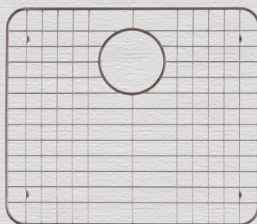

746-STC Sink Tray

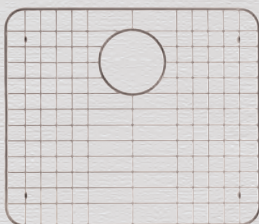

White



Almond



Biscuit



Bone



Platinum



Black

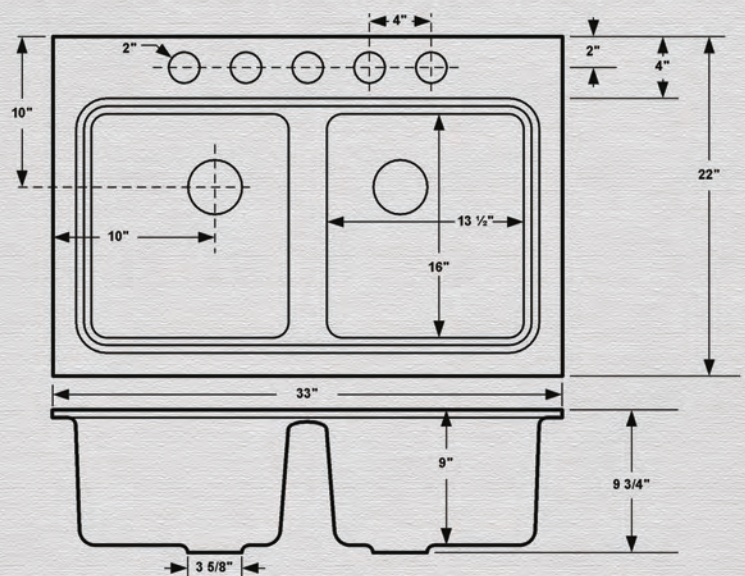

**CECO**

1310 E. Borchard Ave. • Santa Ana, CA 92705 • P 714.656.1950 • F 714.656.1969  
[www.cecocosinks.com](http://www.cecocosinks.com)



748  
UM

# Doheny

Doheny



## D o h e n y

33" x 19.5" x 9" Double Bowl Undermount Kitchen Sink  
Undermount Accessory Kit Included



748-WCB

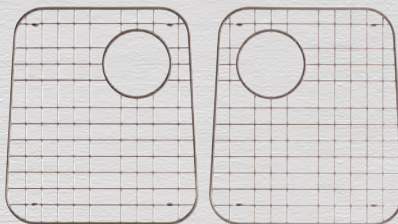

748-STC Sink Tray



White



Almond



Biscuit



Bone



Platinum



Black

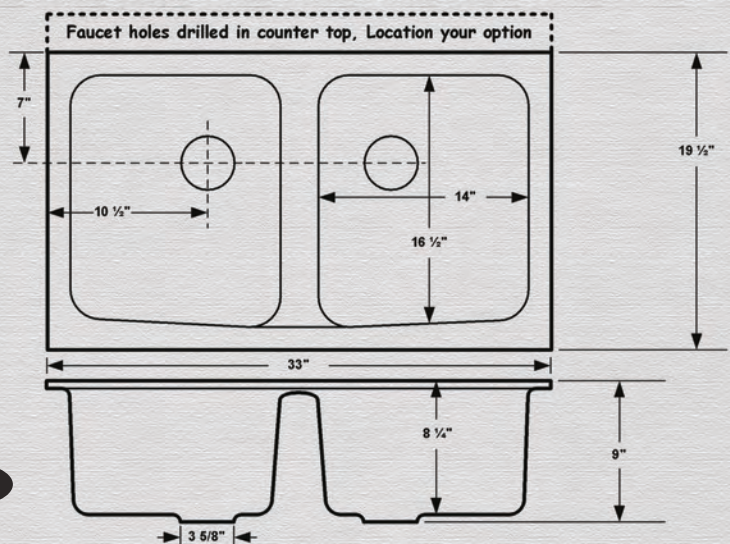

1310 E. Borchard Ave. • Santa Ana, CA 92705 • P 714.656.1950 • F 714.656.1969

[www.cecossinks.com](http://www.cecossinks.com)

**CECO**



# Delray

754  
UM

Delray



## Delray

33" x 19.5" x 9" Single Bowl Undermount Kitchen Sink  
Undermount Accessory Kit Included

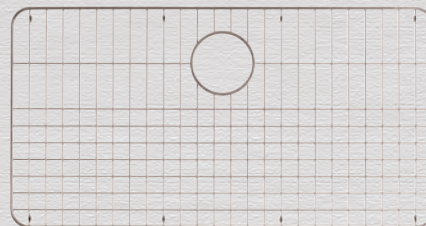
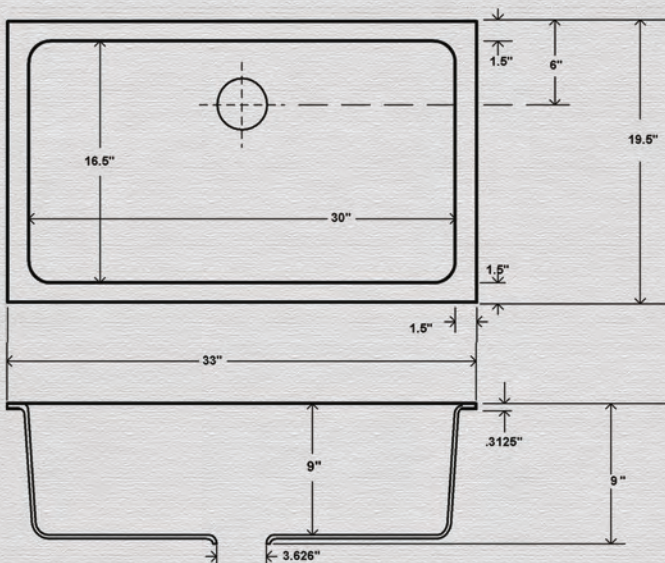

754-STC Sink Tray



754-WCB

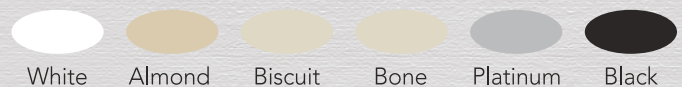

1310 E. Borchard Ave. • Santa Ana, CA 92705 • P 714.656.1950 • F 714.656.1969

[www.cecossinks.com](http://www.cecossinks.com)

# CECO



# Dockweiler

# Dockweiler



33" x 22" x 10.75" Offset Double Bowl Tile Edge Kitchen Sink  
Available with 4 Faucet Holes

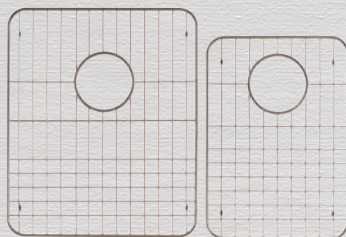

## 768-STC Sink Tray



Black

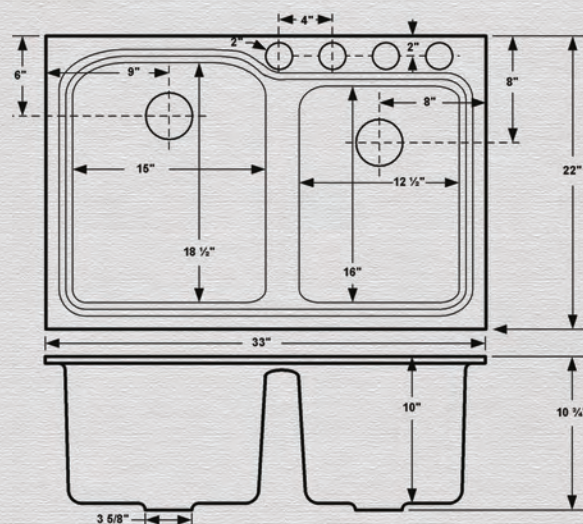

[www.cecossinks.com](http://www.cecossinks.com)

**CECO**



# Windansea

776  
LD  
UM

Windansea



## Windansea

33" x 22" x 9.75" Offset Low Damn  
Undermount Kitchen Sink  
Undermount Accessory Kit Included

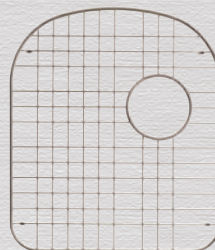
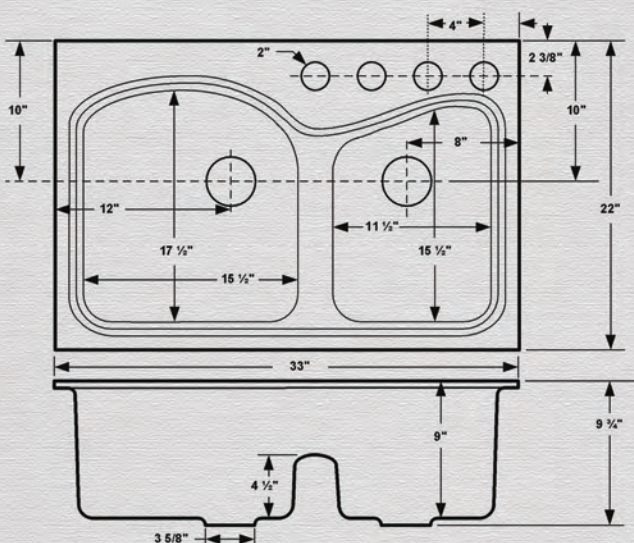

776-STC Sink Tray

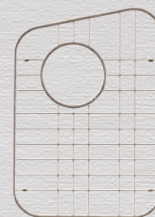

776-WCB



White



Almond



Biscuit



Bone



Platinum



Black

**CECO**

1310 E. Borchard Ave. • Santa Ana, CA 92705 • P 714.656.1950 • F 714.656.1969  
[www.cecokinks.com](http://www.cecokinks.com)



# Newport

33" x 22" Kitchen Sink\*  
Undercounter Mount  
Includes UM 25 Mounting Kit

Accessories (Sold Separately)  
Cutting Board  
Sink Tray

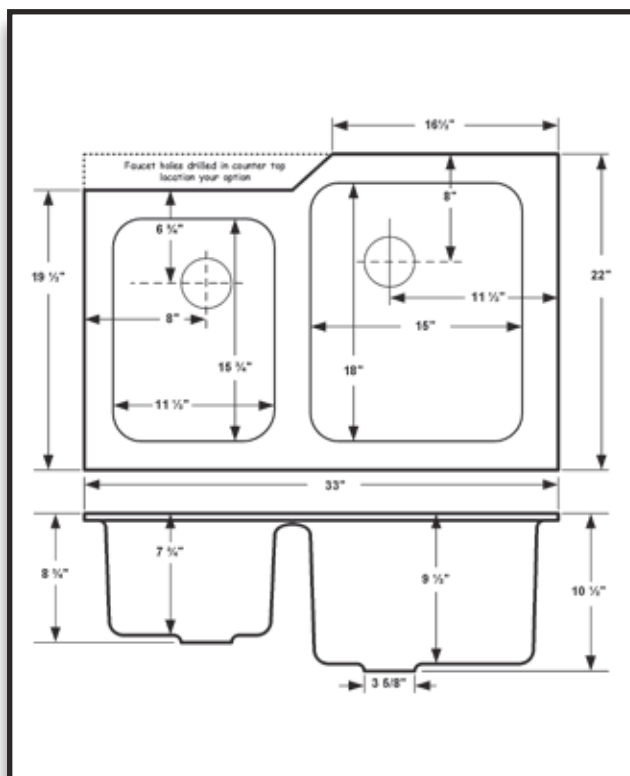

Cat. No.	Size	Depth	Ship Wt.
788-UM	33" x 22"*	8" & 10"	120 lbs.

\*19½" front to back on small bowl

ACID RESISTANT ENAMEL ON CAST IRON

\*Rough-in dimensions may vary 1/4"

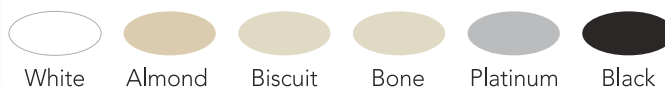



798  
UM

# Northshore



Technical drawing of the sink showing top and side views with dimensions:

- Top View Dimensions:**
  - Overall width: 42"
  - Overall height: 19"
  - Distance between faucet holes: 14"
  - Distance from right faucet hole to right edge: 11"
  - Distance from top edge to faucet hole centerline: 8"
  - Distance from faucet hole centerline to bottom edge: 6 1/2"
  - Distance from faucet hole centerline to bottom edge (for the rightmost hole): 16"
- Side View Dimensions:**
  - Overall depth: 8 3/4"
  - Height of the central basin: 5"
  - Height of the side basins: 8"
  - Distance between side basins: 3 5/8"

**CECO**

1310 E. Borchard Ave. • Santa Ana, CA 92705 • P 714.656.1950 • F 714.656.1969  
[www.cecosinks.com](http://www.cecosinks.com)





1310 E. Borchard Ave. • Santa Ana, CA 92705 • P 714.656.1950 • F 714.656.1969  
[www.cecossinks.com](http://www.cecossinks.com)



# Laundry Sinks

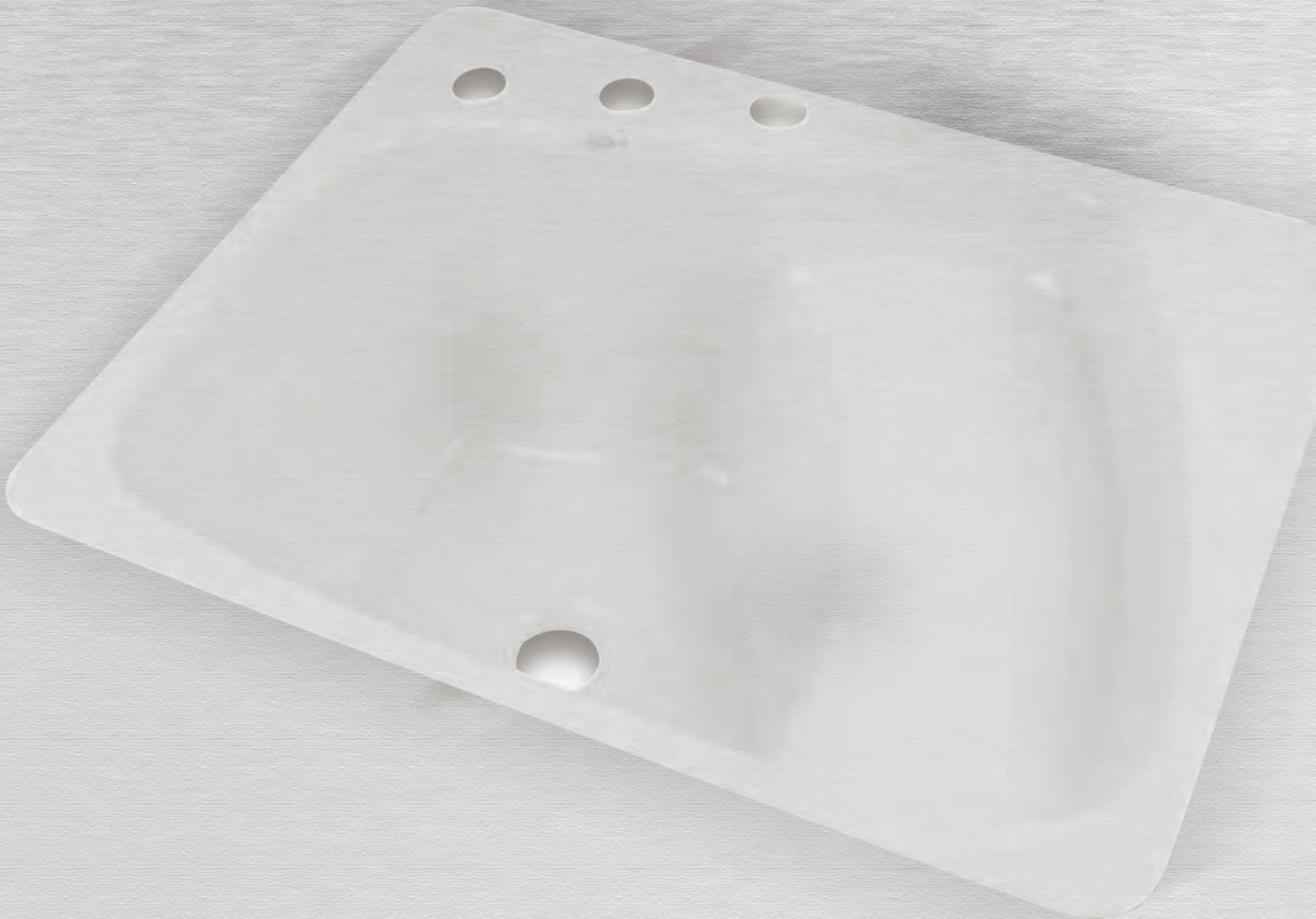



# Laundry Sinks



1310 E. Borchard Ave. • Santa Ana, CA 92705 • P 714.656.1950 • F 714.656.1969  
[www.cecokinks.com](http://www.cecokinks.com)





## La Quinta

16" x 17.5 x 9 Laundry Tray

Undermount Accessory Kit Included



728-WCB

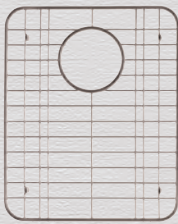

728-STC Sink Tray



White



Almond



Biscuit



Bone



Platinum



Black

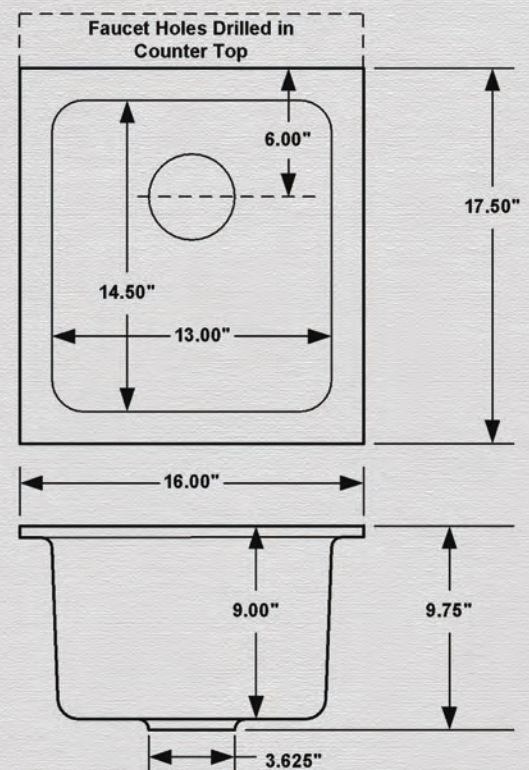



16" x 20" Laundry Tray  
Tile-In or Undercounter Mount  
Flat Rim

Available in 4" or 8" Center Set  
1 Hole Center Drill  
3 1/2" Drain

Accessories (Sold Separately)  
Cutting Board  
Sink Tray



Cat. No.	Size	Depth	Ship Wt.
728	16" x 20"	9"	60 lbs.
728-UM	16" x 17 1/2"	9"	60 lbs

\*No Faucet Deck on 728-UM Model

ACID RESISTANT ENAMEL ON CAST IRON

\*Rough-in dimensions may vary 1/4"

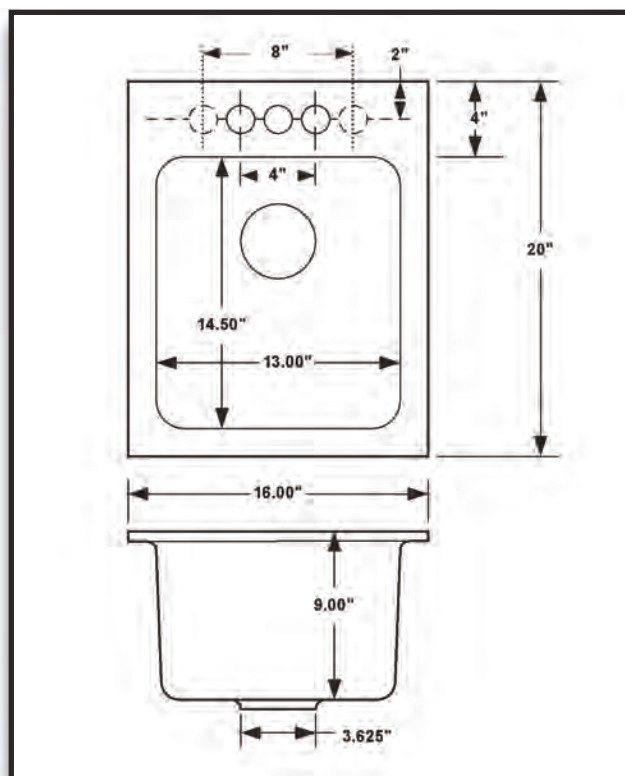
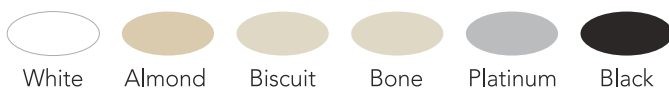





16" x 20" Laundry Tray  
Self Rimming

Available in 4" or 8" Center Set  
1 Hole Center Drill  
3 1/2" Drain

Accessories  
(Sold Separately)  
Cutting Board  
Sink Tray

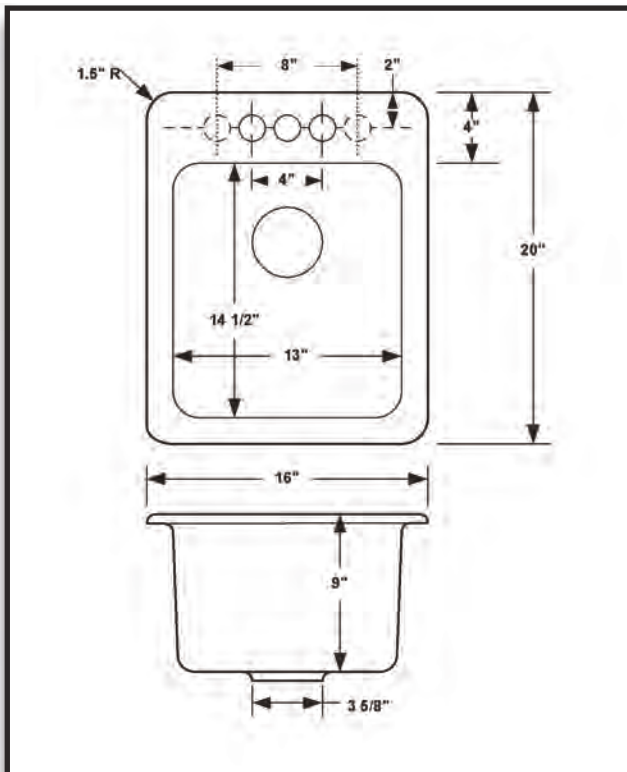

Cat. No.	Size	Depth	Ship Wt.
729	16" x 20"	9"	60 lbs.

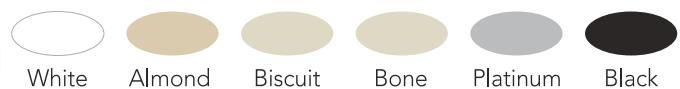



604  
800  
830

Hoodoo

# Hoodoo

Rectangular Laundry Tray  
Tile-In, Rim or undercounter Mount  
Wall Mount with A-Hanger  
or T-Hanger

Accessories (Sold Separately)  
UM 25 Mounting Kit  
Mounting Rim  
Triangle Wall Hanger (604 & 800)  
"T" Wall Hanger (830)  
Adjustable Pedestal



Cat. No.	Size	Depth	Ship Wt.
604	20" x 16"	12"	63 lbs.
800	20" x 18"	12"	68 lbs.
830	24" x 20"	13"	92 lbs.

ACID RESISTANT ENAMEL ON CAST IRON  
\*Rough-in dimensions may vary 1/4"

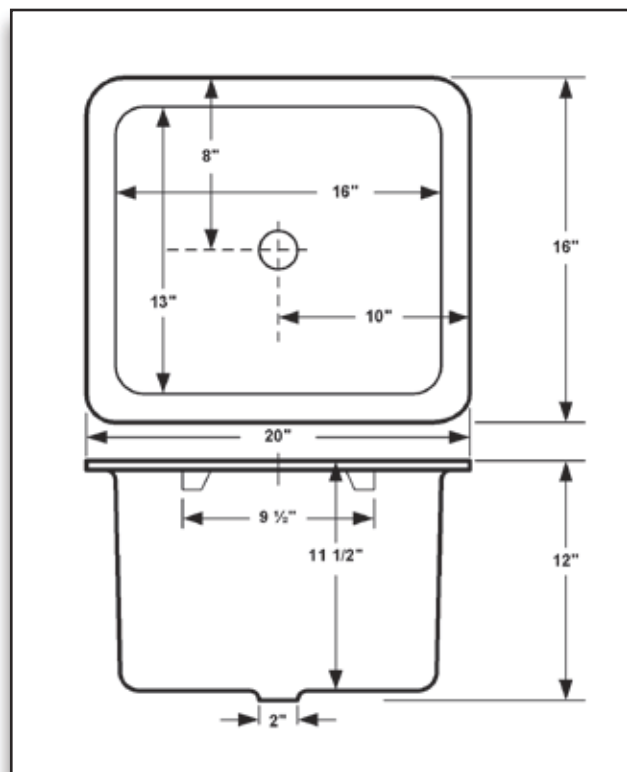

1310 E. Borchard Ave. • Santa Ana, CA 92705 • P 714.656.1950 • F 714.656.1969

[www.cecosinks.com](http://www.cecosinks.com)

**CECO**



24" x 20" Laundry Tray  
Wall Mount only with A-Hanger

Accessories (Sold Separately)  
Triangle Wall Hanger  
Adjustable Pedestal

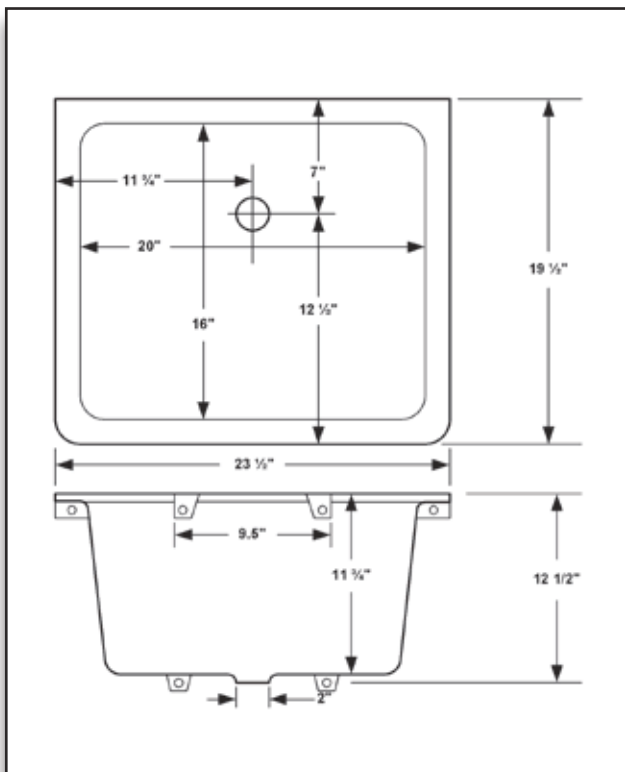

Cat. No.	Size	Depth	Ship Wt.
804	24" x 20"	13"	83 lbs.

ACID RESISTANT ENAMEL ON CAST IRON  
\*Rough-in dimensions may vary 1/4"

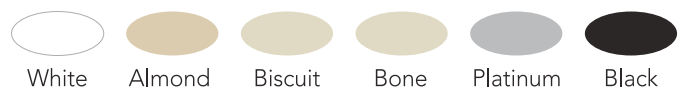



21" x 22" Laundry Sink  
Self Rimming



Cat. No.	Size	Depth	Ship Wt.
807	21" x 22"	12"	80 lbs.

ACID RESISTANT ENAMEL ON CAST IRON  
\*Rough-in dimensions may vary 1/4"

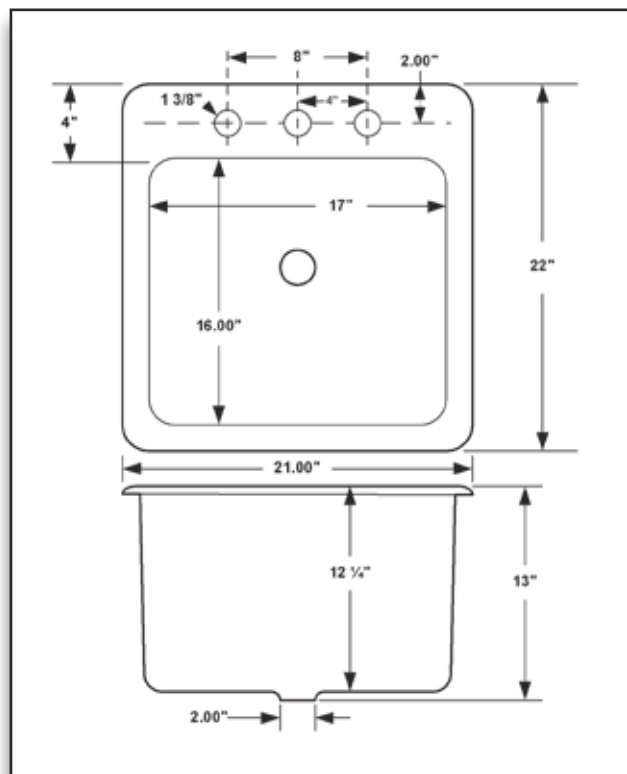
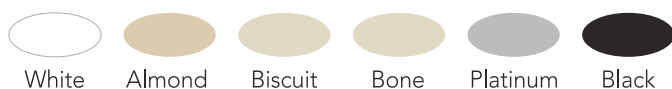



Rectangular Laundry Tray  
Tile, Rim or Undercounter Mount

Accessories (Sold Separately)  
UM 25 Mounting Kit  
Mounting Rim

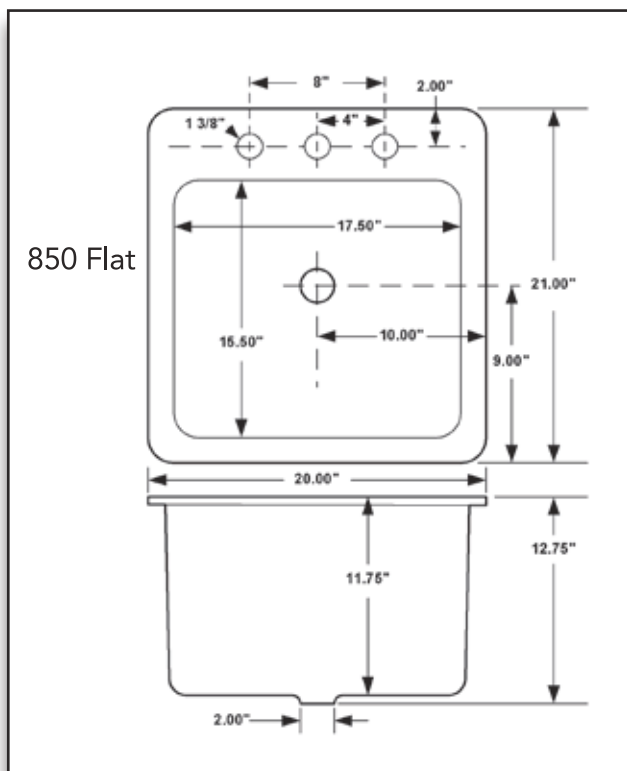

Cat. No.	Size	Depth	Ship Wt.
850	20" x 21"	12"	78 lbs.
855	24" x 21"	12"	95 lbs.

ACID RESISTANT ENAMEL ON CAST IRON  
\*Rough-in dimensions may vary 1/4"

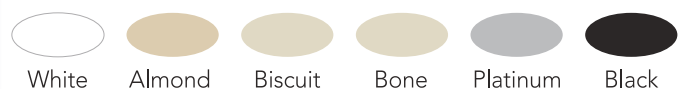



857

# Big Horn

25" x 22" Laundry Tray  
Self Rimming

Available with 5 oversized holes  
for undermount installation



Cat. No.	Size	Depth	Ship Wt.
857	25" x 22"	13"	105 lbs.

ACID RESISTANT ENAMEL ON CAST IRON  
\*Rough-in dimensions may vary 1/4"

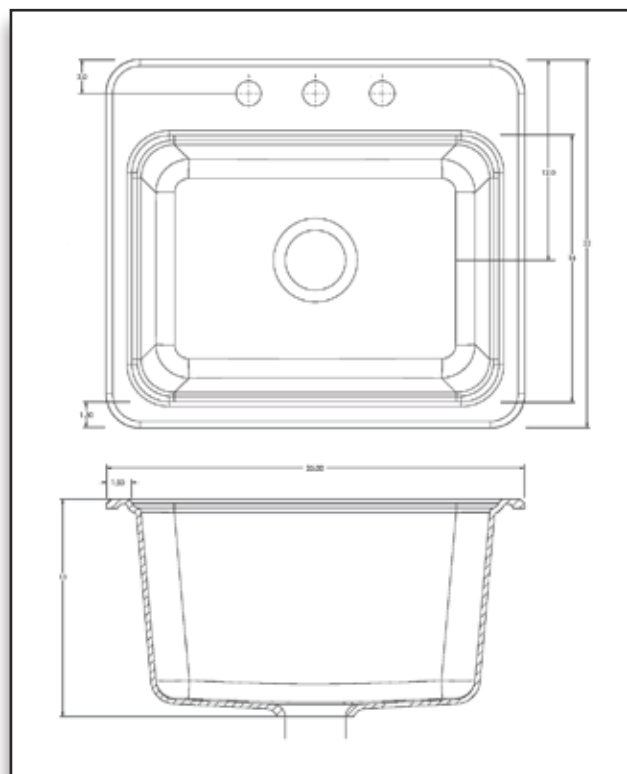

1310 E. Borchard Ave. • Santa Ana, CA 92705 • P 714.656.1950 • F 714.656.1969

[www.cecosinks.com](http://www.cecosinks.com)

**CECO**

Big Horn



# Big Horn

857  
UM

25" x 22" Laundry Tray

Available with 5 oversized holes  
for undermount installation



Big Horn

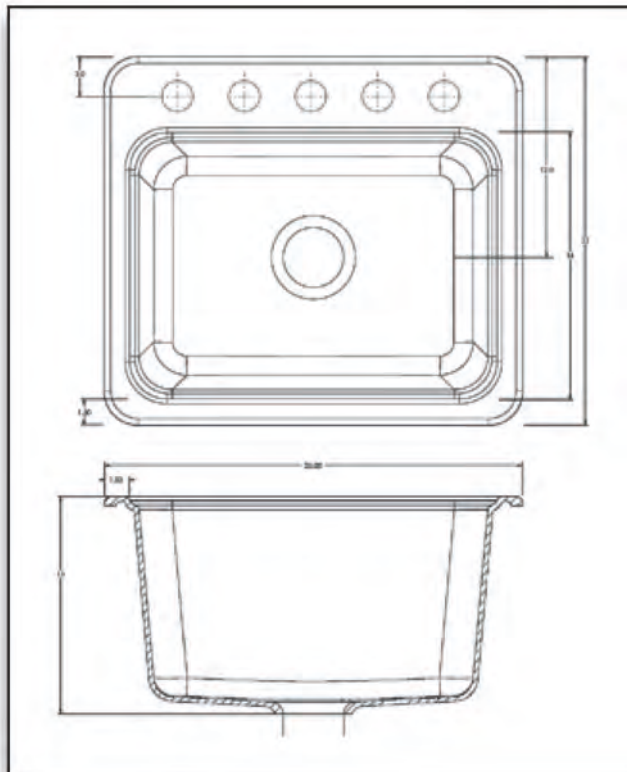

Cat. No.	Size	Depth	Ship Wt.
857	25" x 22"	13"	105 lbs.

ACID RESISTANT ENAMEL ON CAST IRON

\*Rough-in dimensions may vary 1/4"

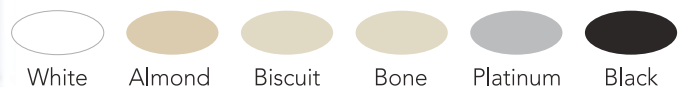

1310 E. Borchard Ave. • Santa Ana, CA 92705 • P 714.656.1950 • F 714.656.1969

[www.cecossinks.com](http://www.cecossinks.com)

**CECO**



# Mammoth

26" x 21" Laundry Tray  
Tile, Rim or Undercounter Mount

Accessories (Sols Separately)  
R2126 Mounting Rim

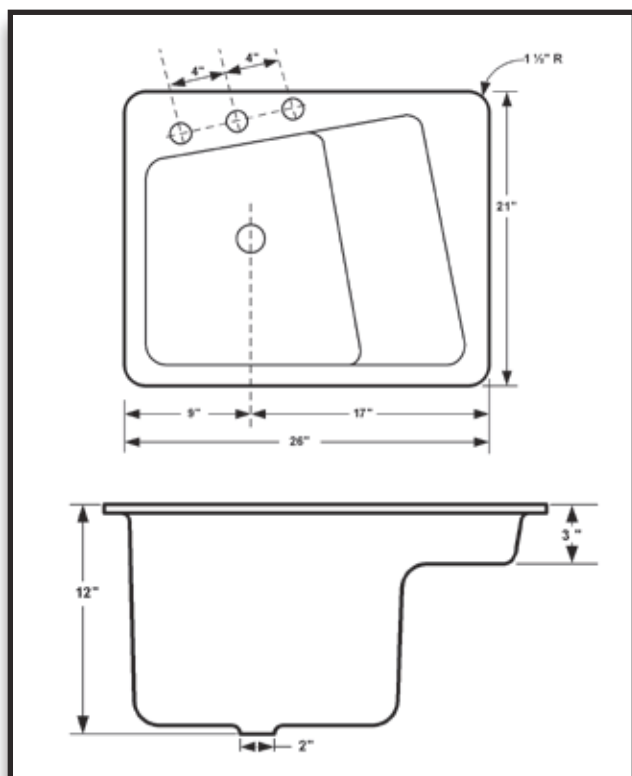

Cat. No.	Size	Depth	Ship Wt.
860	26" x 21"	12"	85 lbs.

ACID RESISTANT ENAMEL ON CAST IRON  
\*Rough-in dimensions may vary 1/4"

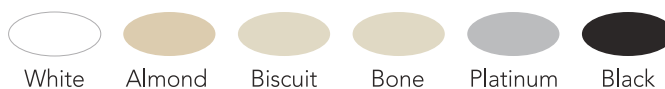

**CECO**

1310 E. Borchard Ave. • Santa Ana, CA 92705 • P 714.656.1950 • F 714.656.1969  
[www.cecosinks.com](http://www.cecosinks.com)



# Commercial



1310 E. Borchard Ave. • Santa Ana, CA 92705 • P 714.656.1950 • F 714.656.1969  
[www.cecosinks.com](http://www.cecosinks.com)

**CECO**



# Commercial



1310 E. Borchard Ave. • Santa Ana, CA 92705 • P 714.656.1950 • F 714.656.1969  
[www.cecossinks.com](http://www.cecossinks.com)



# 540•541

540  
541



19" x 17" Rectangular Lavatory  
Wall Hung Installation  
Includes Hanger

Available in A & B modifications  
A Modification - Carrier Arms  
B Modification - Anchor Lugs

540•541

Cat. No.	Size	Specs			Ship Wt.
		N	R	S	
540-8"cc	19" x 17"	3 5/8"	8"	3 1/2"	55 lbs.
541-4"cc	19" x 17"	3 5/8"	8"	3 1/2"	55 lbs.

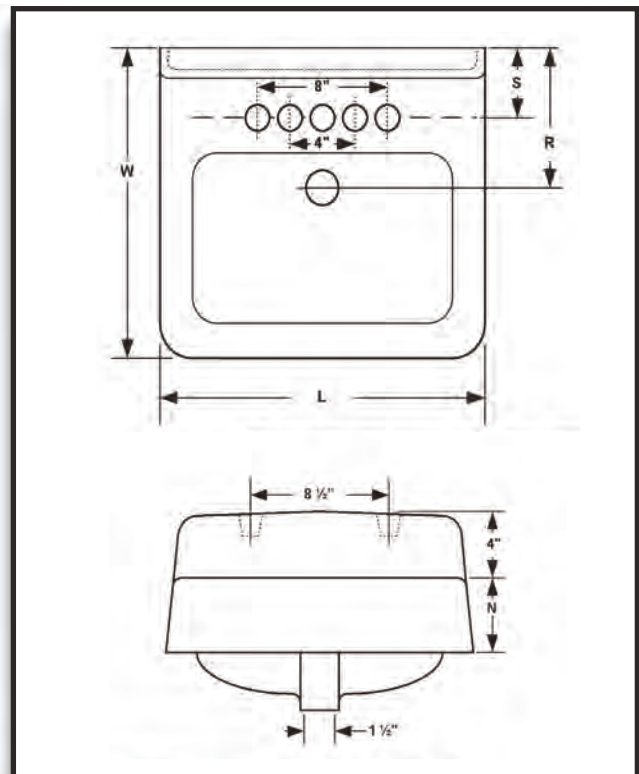



550  
551

# 550•551

20" x 18" Rectangular Lavatory  
Wall Hung Installation  
Includes Hanger

Available in A & B modifications  
A Modification - Carrier Arms  
B Modification - Anchor Lugs



550•551

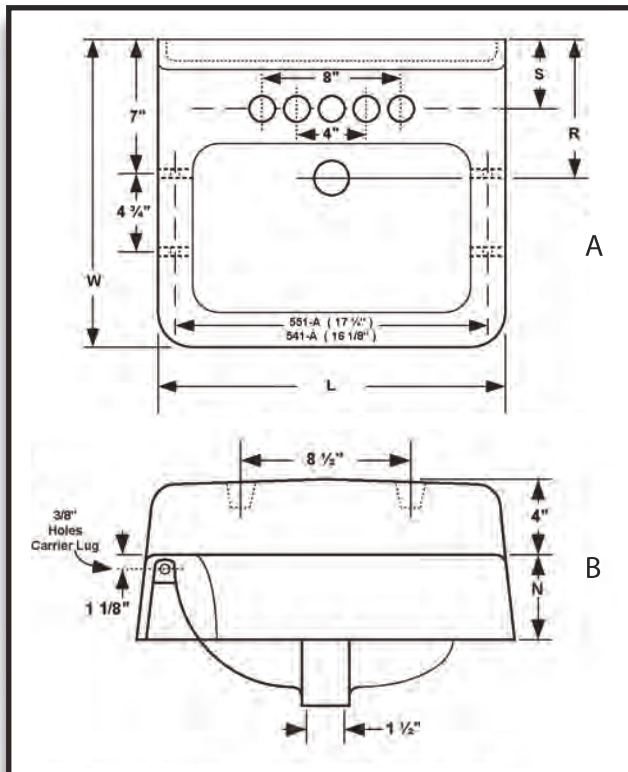

Cat. No.	Size	Specs			Ship Wt.
		N	R	S	
550-8"cc	20" x 18"	4 1/2"	8"	4 1/4"	60 lbs.
551-4"cc	20" x 18"	4 1/2"	8"	4 1/4"	60 lbs.

**CECO**

1310 E. Borchard Ave. • Santa Ana, CA 92705 • P 714.656.1950 • F 714.656.1969  
[www.cecosinks.com](http://www.cecosinks.com)



20" x 18" Enamel cast iron wall-hung lavatory

Includes: Mounting Bracket, Overflow and Cast-In Soap Dish



Cat. No.	Size	Depth	Ship Wt.
553-4"cc	20" x 18"	4 1/2"	63 lbs.

ACID RESISTANT ENAMEL ON CAST IRON  
\* Fully ADA Compliant

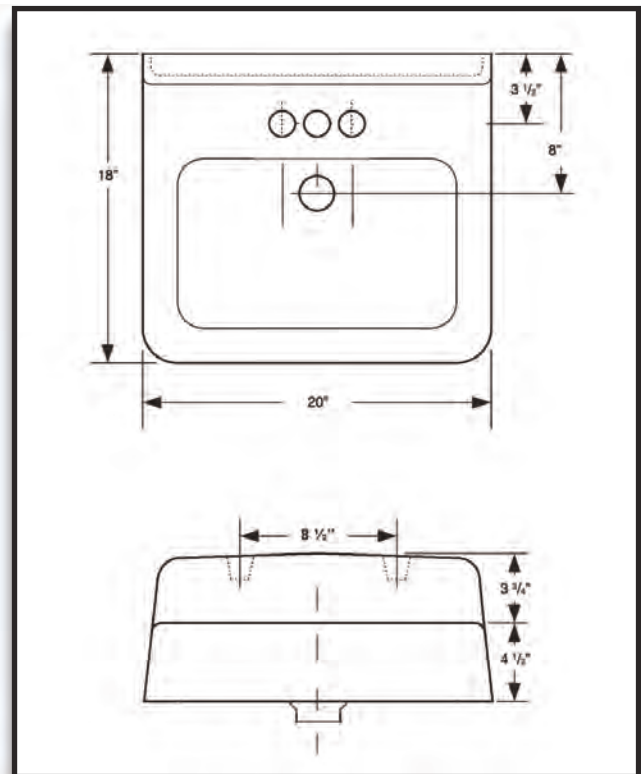



865  
866

# 865•866

Service Sink  
Wall Hung Installation  
Includes Hanger

Drilled for and includes  
stainless steel rim guard

Accessories (Sold Separately)  
870 2" and 3" Trap Standard



865•866

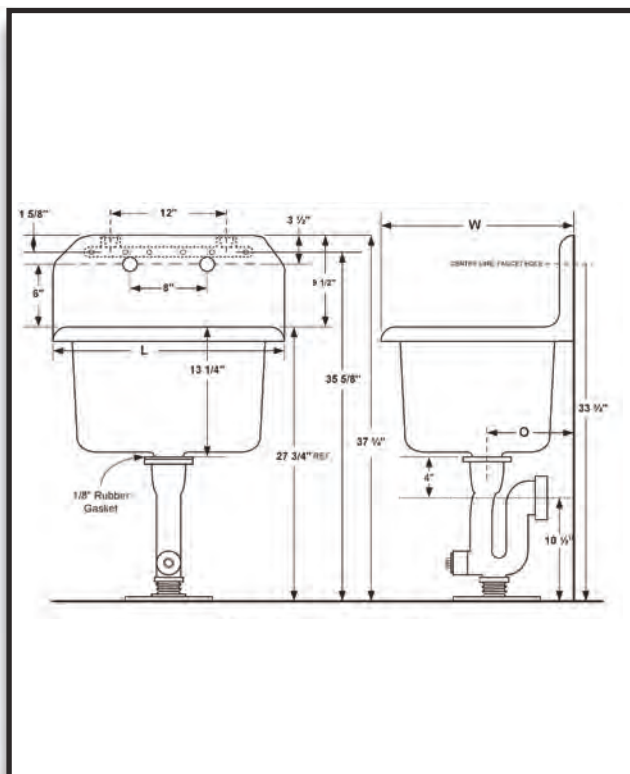

Cat. No.	Size	Specs			Ship Wt.
		L	W	O	
865	22" x 18"	22"	18"	9"	90 lbs.
866	24" x 20"	24"	20"	10"	109 lbs.

ACID RESISTANT ENAMEL ON CAST IRON

**CECO**

1310 E. Borchard Ave. • Santa Ana, CA 92705 • P 714.656.1950 • F 714.656.1969  
www.cecossinks.com



# 867•868

867  
868

Service Sink  
Wall Hung Installation  
Includes Hanger

Drilled for and includes  
stainless steel rim guard

Accessories (Sold Separately)  
870 2" and 3" Trap Standard



867•868

Cat. No.	Size	Specs			Ship Wt.
		L	W	O	
867	22" x 18"	22"	18"	9"	90 lbs.
868	24" x 20"	24"	20"	10"	109 lbs.

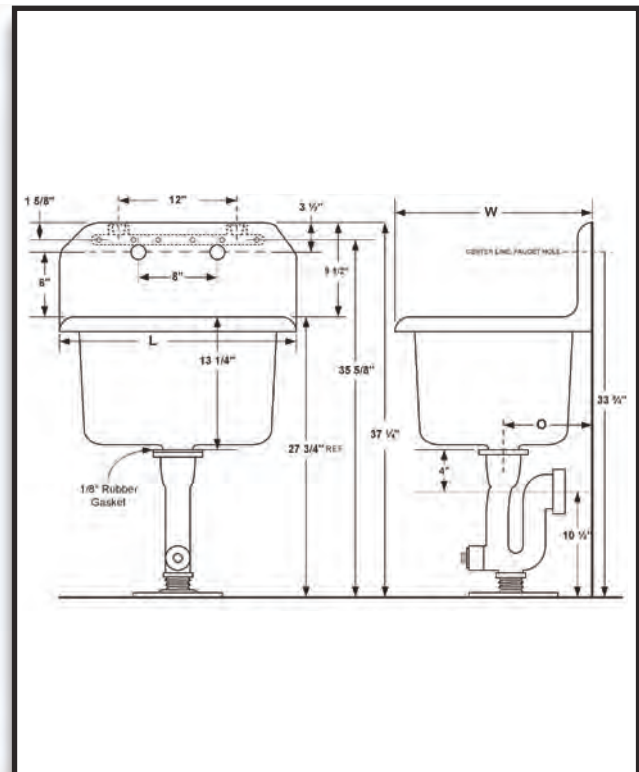



28" x 28" Corner Service Sink  
Available with B-872 coated  
wire rim guard

Accessories (Sold Separately)

Drains

B-71-2" IP

B-71-2" Caulk

B-71-3" IP

B-71-3" Caulk

872-Wire Rim Guards

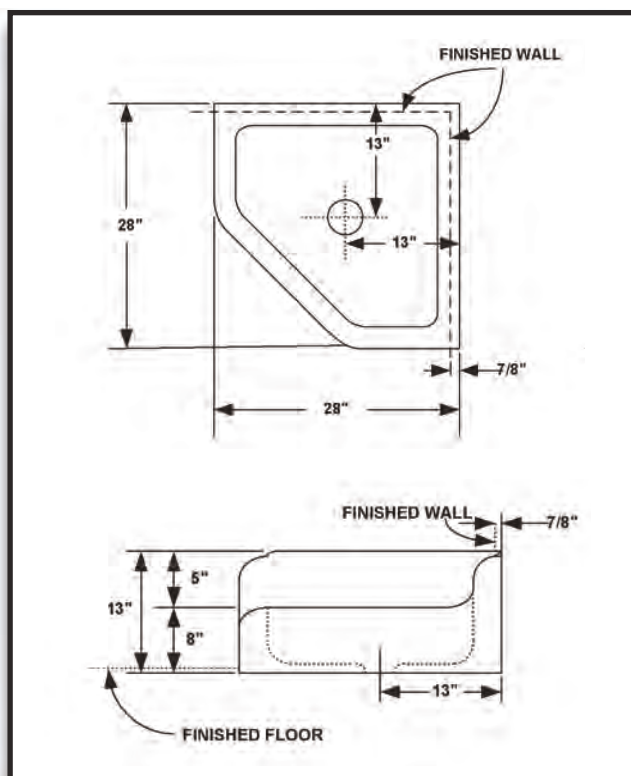

Cat. No.	Size	Specs	Ship Wt.
871	28" x 28"	8"	163 lbs.



# 906•908•910

906  
908  
910

906•908•910

## 12" x 12" Floor Sink

Acid Resistant Enamel on Cast Iron  
Includes Dome Strainer

Available in Caulk & No Hub  
2", 3" and 4" Outlet

Accessories (Sold Separately)  
Plastic Sediment Bucket  
Top Grate



Cat. No.	Size	Outlet			Ship Wt.
		C-ID	C-OD	D	
906-2"	12" x 12" x 6"	2 5/8"	2 1/4"	6"	27 lbs.
906-3"	12" x 12" x 6"	3 5/8"	3 1/4"	6"	27 lbs.
906-4"	12" x 12" x 6"	4 5/8"	4 1/4"	6"	27 lbs.
908-2"	12" x 12" x 8"	2 5/8"	2 1/4"	8 1/2"	32 lbs.
908-3"	12" x 12" x 8"	3 5/8"	3 1/4"	8 1/2"	32 lbs.
908-4"	12" x 12" x 8"	4 5/8"	4 1/4"	8 1/2"	32 lbs.
910-2"	12" x 12" x 10"	2 5/8"	2 1/4"	10 1/2"	36 lbs.
910-3"	12" x 12" x 10"	3 5/8"	3 1/4"	10 1/2"	36 lbs.
910-4"	12" x 12" x 10"	4 5/8"	4 1/4"	10 1/2"	36 lbs.

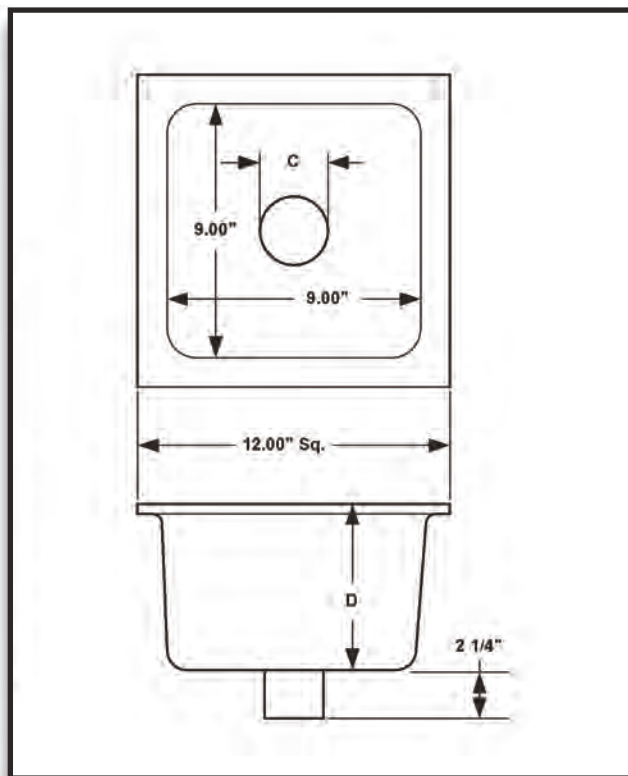



906-1  
908-1  
910-1

# 906-1•908-1•910-1

906-1•908-1•910-1

12" x 12" Floor Sink with Seepage Flange\*

Acid Resistant Enamel on Cast Iron  
Includes Dome Strainer

Available in Caulk & No Hub  
2", 3" and 4" Outlet

Accessories (Sold Separately)  
Plastic Sediment Bucket  
Top Grate

\*Flange Dimension 15" x 15"

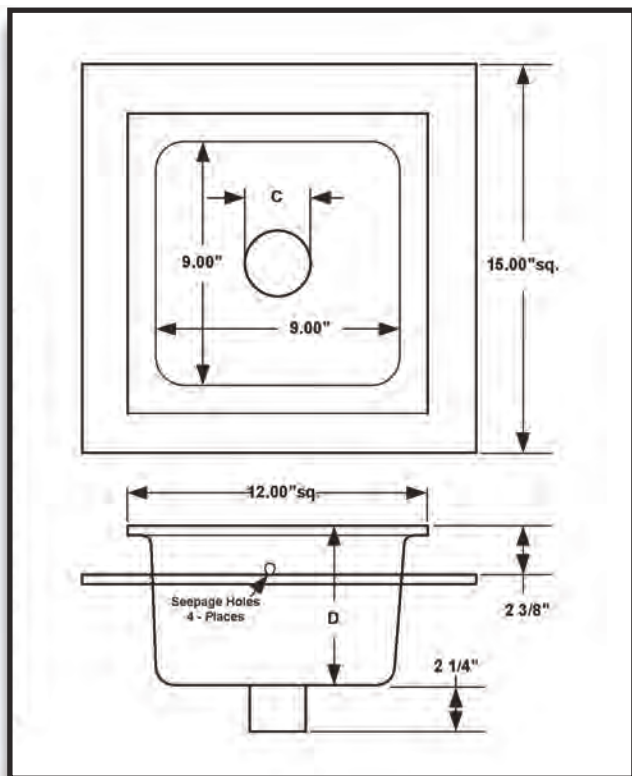

Cat. No.	Size	Outlet		Ship Wt.	
		C-ID	C-OD	D	
906-1-2"	12" x 12" x 6"	2 5/8"	2 1/4"	6"	30 lbs.
906-1-3"	12" x 12" x 6"	3 5/8"	3 1/4"	6"	30 lbs.
906-1-4"	12" x 12" x 6"	4 5/8"	4 1/4"	6"	30 lbs.
908-1-2"	12" x 12" x 8"	2 5/8"	2 1/4"	8 1/2"	35 lbs.
908-1-3"	12" x 12" x 8"	3 5/8"	3 1/4"	8 1/2"	35 lbs.
908-1-4"	12" x 12" x 8"	4 5/8"	4 1/4"	8 1/2"	35 lbs.
910-1-2"	12" x 12" x 10"	2 5/8"	2 1/4"	10 1/2"	40 lbs.
910-1-3"	12" x 12" x 10"	3 5/8"	3 1/4"	10 1/2"	40 lbs.
910-1-4"	12" x 12" x 10"	4 5/8"	4 1/4"	10 1/2"	40 lbs.

**CECO**

1310 E. Borchard Ave. • Santa Ana, CA 92705 • P 714.656.1950 • F 714.656.1969  
[www.cecossinks.com](http://www.cecossinks.com)



## 12" Round Floor Sink

Acid Resistant Enamel on Cast Iron  
Includes Dome Strainer

Available in Caulk & No Hub  
2", 3" and 4" Outlet

Accessories (Sold Separately)  
Plastic Sediment Bucket  
Top Grate



Cat. No.	Size	Outlet			Ship Wt.
		C-ID	C-OD	D	
1008-2"	12" Round x 8	2 1/4"	2 5/8"	8"	30 lbs.
1008-3"	12" Round x 8	3 1/4"	3 5/8"	8"	30 lbs.
1008-4"	12" Round x 8	4 1/4"	4 5/8"	8"	30 lbs.

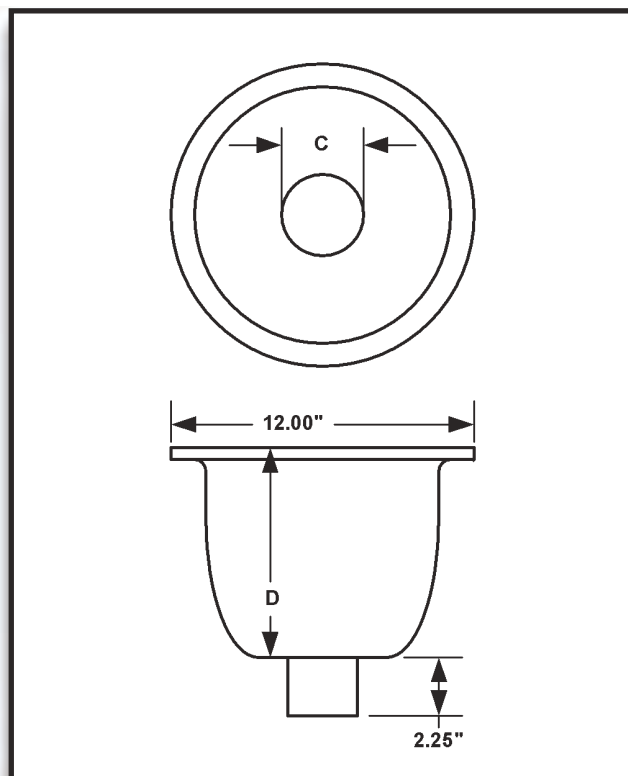



# 1008-1

12" Round Floor Sink with Seepage Flange\*

Acid Resistant Enamel on Cast Iron  
Includes Dome Strainer

Available in Caulk & No Hub  
2", 3" and 4" Outlet

Accessories (Sold Separately)  
Plastic Sediment Bucket  
Top Grate

\*Flange Dimension 15" Diameter

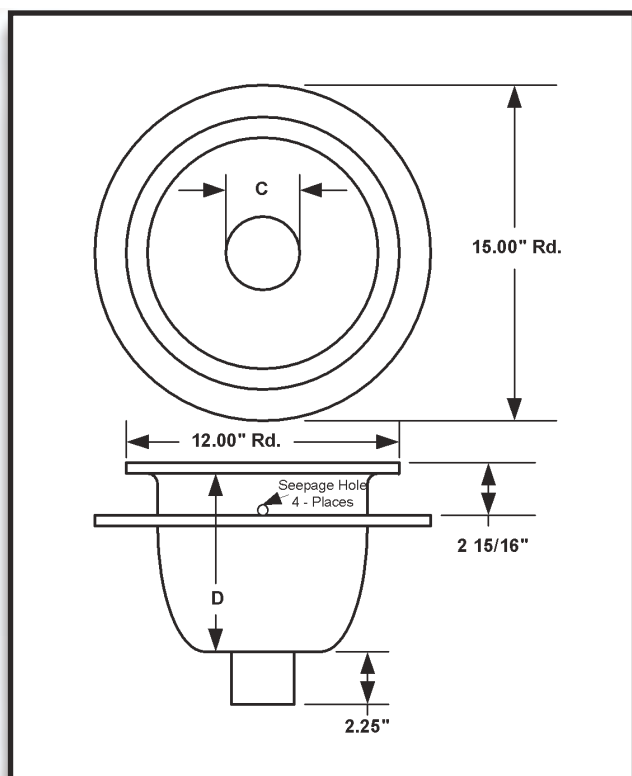

Cat. No.	Size	Outlet			Ship Wt.
		C-ID	C-OD	D	
1008-1-2"	12" Round x 8	2 1/4"	2 5/8"	8"	35 lbs.
1008-1-3"	12" Round x 8	3 1/4"	3 5/8"	8"	35 lbs.
1008-1-4"	12" Round x 8	4 1/4"	4 5/8"	8"	35 lbs.



# Commercial

## FLOOR SINKS

Acid Resistant Enamel on Cast Iron

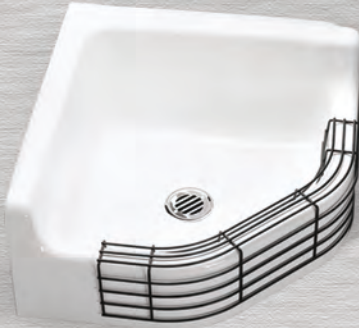

872 Wire Rim Guards



900 Full Top Grate



\* 902 Dome Strainer



912 Half Top Grate



912-2 Split Half  
Top Grate



934 3/4 Top Grate



1000 Full Round  
Top Grate



1034 3/4 Round  
Top Grate



1012 1/2 Round  
Top Grate

\* (Cast Aluminum - Not Enameled)



# Commercial

Commercial

## SEDIMENT BUCKETS

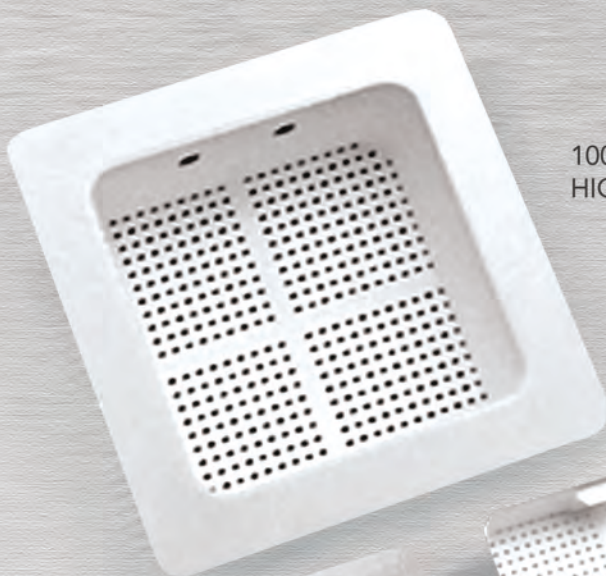

1001 Sediment Bucket  
HIGH IMPACT PLASTIC

1004 Sediment Bucket Round  
HIGH IMPACT PLASTIC (Not Shown)



1003 Sediment Bucket  
HIGH IMPACT PLASTIC

1002 Sediment Bucket  
HIGH IMPACT PLASTIC

## MOUNTS / PEDESTAL / DRAINS



T Wall Hanger



A / Triangle Wall Hanger



B-71 2" Drains  
IP or Caulk for 871



Adjustable  
Pedestal / Stand

**CECO**

1310 E. Borchard Ave. • Santa Ana, CA 92705 • P 714.656.1950 • F 714.656.1969  
[www.cecocosinks.com](http://www.cecocosinks.com)





### **CECO Milestones**

CECO offers a limited lifetime warranty on a wide range of plumbing fixture designs, makes, and models, including a variety of discontinued products no longer offered by competitors.

CECO products are readily available to be shipped nationwide from their distribution center headquartered in Santa Ana, California, or from regional warehouses strategically located throughout the country.

CECO has formed strategic global partnerships and streamlined their manufacturing, distribution, and triple-inspection process to ensure a superior product each and every time.

# **CECO**

QUALITY & STYLE | SYNCHRONIZED



QUALITY & STYLE | SYNCHRONIZED

Available Sink Color Options



White



Almond



Biscuit



Bone



Platinum



Black

***CECO***

PORCELAIN ENAMELED CAST IRON KITCHEN SINKS

1310 E. Borchard Ave.

Santa Ana, CA 92705

Office: (714) 656-1950

Sales: (800) 362-6354

Fax: (714) 656-1969

[cecosinks.com](http://cecosinks.com)